

Facilities and Construction Layout Drawing Watson Ranch Pad Section 17, Township 7 South, Range 95 West

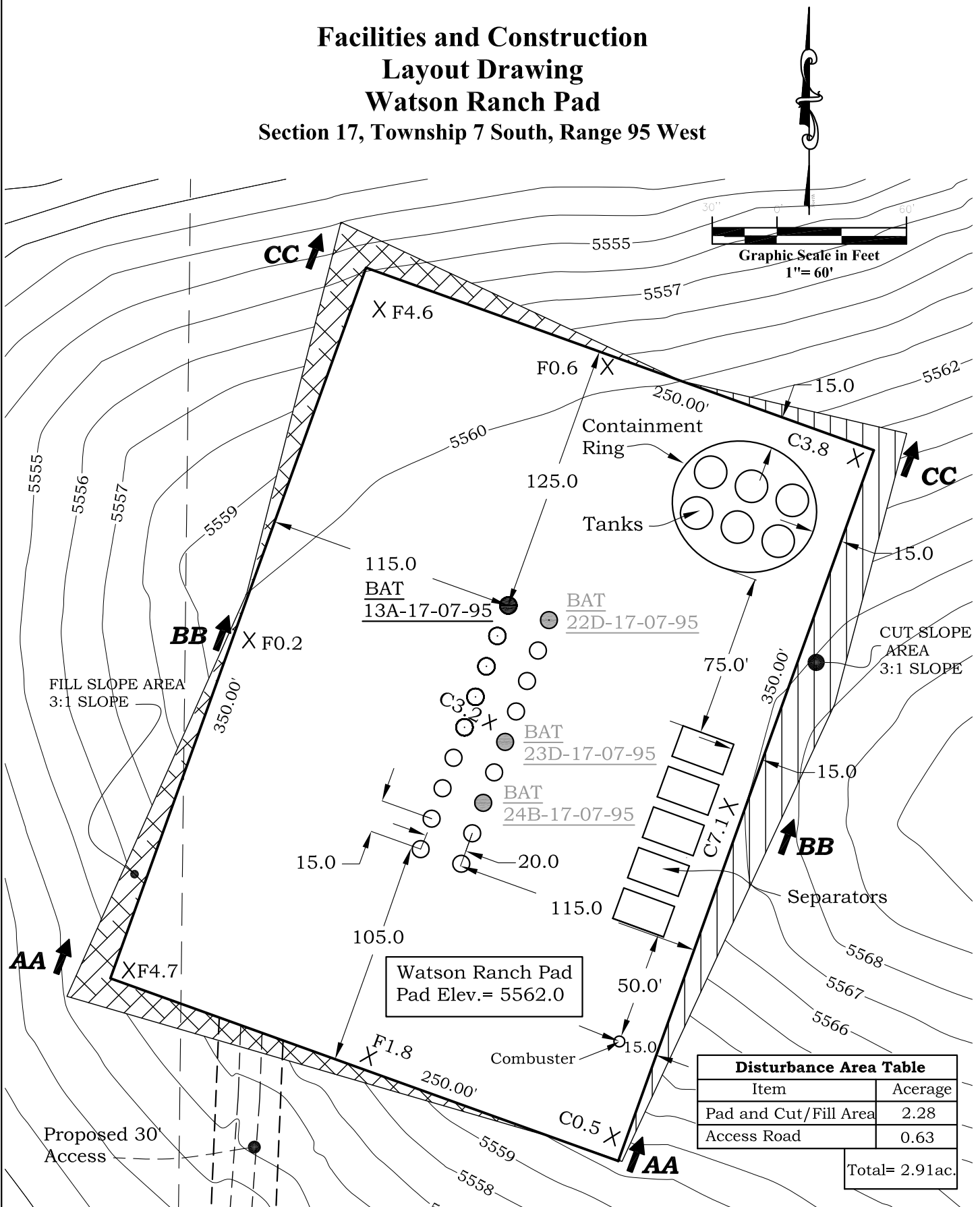

River Valley Survey, Inc.
110 East 3rd. Street, Suite 213
Rifle, Colorado 81650
Ph: 970-379-7846

Project: WATSON RANCH PAD

Field Date: 06-19-09

Date: 11-12-09

Scale: 1"= 60'

Sheet: 4 of 9

**Well Location Plat
Prepared For Antero Resources**

Situate In:
SE1/4SW1/4 Section 17, T7S., R. 95 W. of
the 6th P.M., Garfield County, Colorado

