

State of Colorado Oil and Gas Conservation Commission

1120 Lincoln Street, Suite 801, Denver, Colorado 80203 (303)894-2100 Fax:(303)894-2109



FOR OGCC USE ONLY

EARTHEN PIT REPORT/PERMIT

This form is to be used for both reporting and permitting pits. Rule 903 describes when a Permit with prior approval, or a Report within 30 days, is required for pits. Submit required attachments and forms.

Complete the Attachment Checklist

FORM SUBMITTED FOR:

☐ Pit Report

☐ Pit Permit

	Oper	OGCC
Detailed Site Plan		
Topo Map w/ Pit Location		
Water Analysis (Form 25)		
Source Wells (Form 26)		
Pit Design/Plan & Cross Sect		
Design Calculations		
Sensitive Area Determ.		
Mud Program		
Form 2A		

OGCC Operator Number: 100322

Name of Operator: NOBLE ENERGY INC.

Address: 1625 BROADWAY, SUITE 2200

City: DENVER State: Co Zip: 80202

Contact Name and Telephone:

LINDA J PAVELKA

No: 303-228-4064

Fax: 3003-228-4264

API Number (of associated well): _____ OGCC Facility ID (of other associated facility): 288687

Pit Location (QtrQtr, Sec, Twp, Rng, Meridian): NESW, Sec. 1, T8S, R96W 1K Well Pad

Latitude: _____ Longitude: _____ County: Weld

Pit Use: ☐ Production ☐ Drilling (Attach mud program) ☒ Special Purpose (Describe Use): Processed WaterPit Type: ☒ Lined ☐ Unlined Surface Discharge Permit: ☐ Yes ☒ NoOffsite disposal of pit contents: ☐ Injection ☐ Commercial Pit/Facility Name: _____ Pit/Facility No: _____

Attach Form 26 to identify Source Wells and Form 25 to provide Produced Water Analysis results.

Existing Site Conditions

Is the location in a "Sensitive Area?" ☐ Yes ☒ No Attach data used for determination.

Distance (in feet) to nearest surface water: 2300' ground water: n/a water wells: n/a

LAND USE (or attach copy of Form 2A if previously submitted for associated well) Select one which best describes land use:Crop Land: ☐ Irrigated ☒ Dry Land ☐ Improved Pasture ☐ Hay Meadow ☐ CRPNon-Crop Land: ☒ Rangeland ☐ Timber ☐ Recreational ☐ Other (describe): _____Subdivided: ☐ Industrial ☐ Commercial ☐ Residential

SOILS (or attach copy of Form 2A if previously submitted for associated well)

Soil map units from USNRCS survey: Sheet No: _____ Soil Complex/Series No: 56

Soils Series Name: Potts Loam, 6-12% slopes Horizon thickness (in inches): A: _____ ; B: _____ ; C: _____

Soils Series Name: _____ Horizon thickness (in inches): A: _____ ; B: _____ ; C: _____

Attach detailed site plan and topo map with pit location.

Pit Design and Construction

Size of pit (feet): Length: 100' Width: 50' Depth: 15'

Calculated pit volume (bbls): 11576 Daily inflow rate (bbls/day): 10-20

Daily disposal rates (attach calculations): Evaporation: _____ bbls/day Percolation: _____ bbls/day

Type of liner material: GEONET Thickness: 200 ML

Attach description of proposed design and construction (include sketches and calculations).

Method of treatment of produced water prior to discharge into pit (separator, heater treater, other): separator

Is pit fenced? ☒ Yes ☐ No Is pit netted? ☐ Yes ☒ No

I hereby certify that the statements made in this form are, to the best of my knowledge, true, correct, and complete.

Print Name: LINDA PAVELKA

Signed:

Title: REGULATORY MANAGER

Date: 10/13/2009

OGCC Approved: _____ Title: _____ Date: _____

CONDITIONS OF APPROVAL, IF ANY:

FACILITY NUMBER:

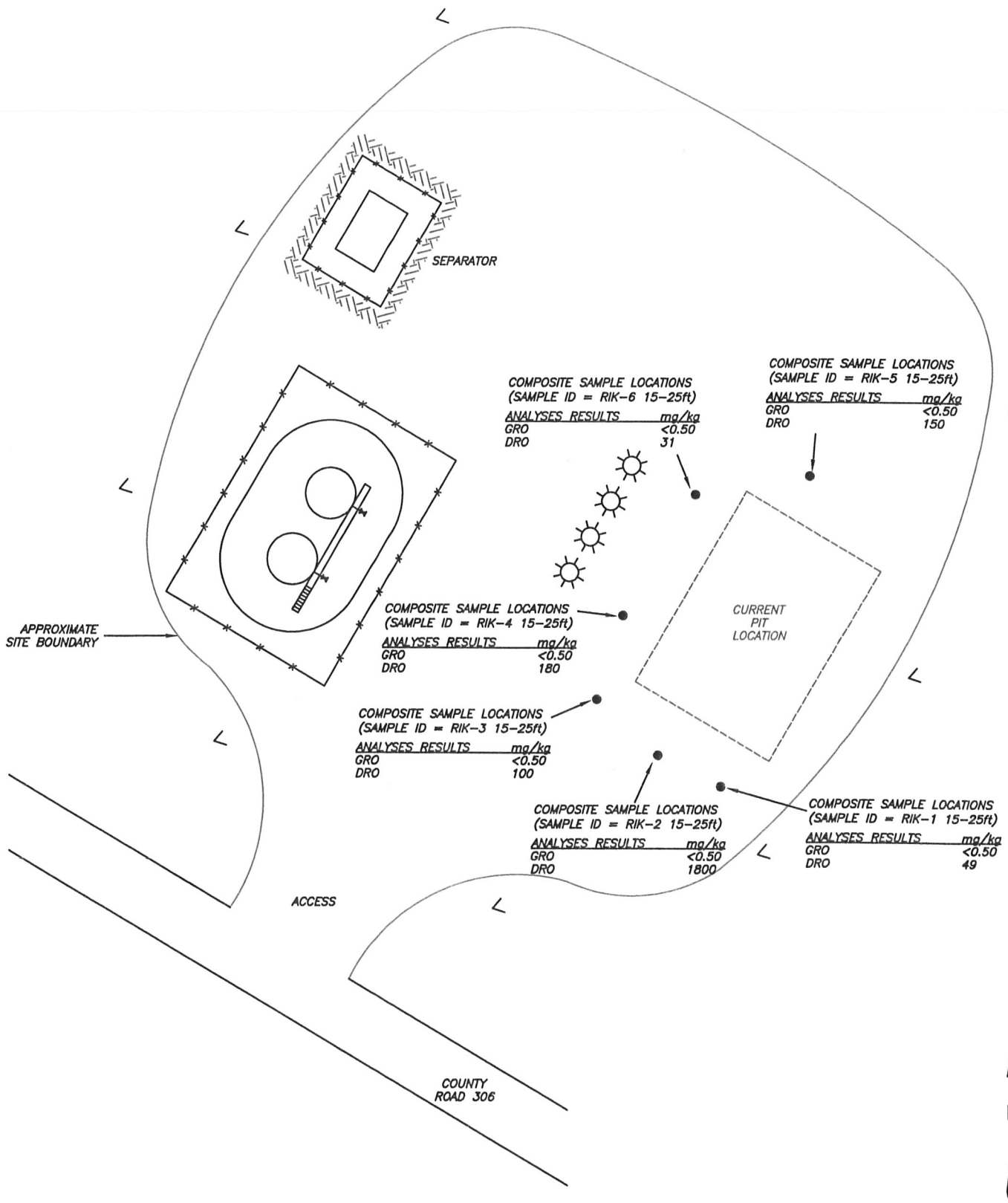

**BOREHOLE LOCATION MAP
NOBLE ENERGY, INC.
RAMOS 1-K PAD
GARFIELD COUNTY, COLORADO**

REVISION DATE:	12/31/07
REVISION NUMBER:	00
DRAWN BY:	BVD
APPROVED BY:	TPD
PROJECT #	EG07297
SCALE:	NONE



Map Unit Description

Rifle Area, Colorado, Parts of Garfield and Mesa Counties

56 Potts loam, 6 to 12 percent slopes

Setting

Elevation: 5000 to 7000 feet

Composition

Potts and similar soils: 85 percent

Description of Potts

Setting

Landform: Valley sides, benches, mesas

Down-slope shape: Convex, linear

Across-slope shape: Convex, linear

Parent material: Alluvium derived from basalt and/or alluvium derived from sandstone and shale

Properties and Qualities

Slope: 6 to 12 percent

Drainage class: Well drained

Capacity of the most limiting layer to transmit water (Ksat): Moderately high (0.20 to 0.60 in/hr)

Frequency of flooding: None

Frequency of ponding: None

Calcium carbonate maximum: 15 percent

Gypsum maximum: 0 percent

Available water capacity: High (about 10.3 inches)

Interpretive Groups

Land capability classification (irrigated): 4e

Land capability (non irrigated): 4e

Ecological site: Rolling Loam (R048AY298CO)

Typical Profile

0 to 4 inches: loam

4 to 28 inches: clay loam

28 to 60 inches: loam

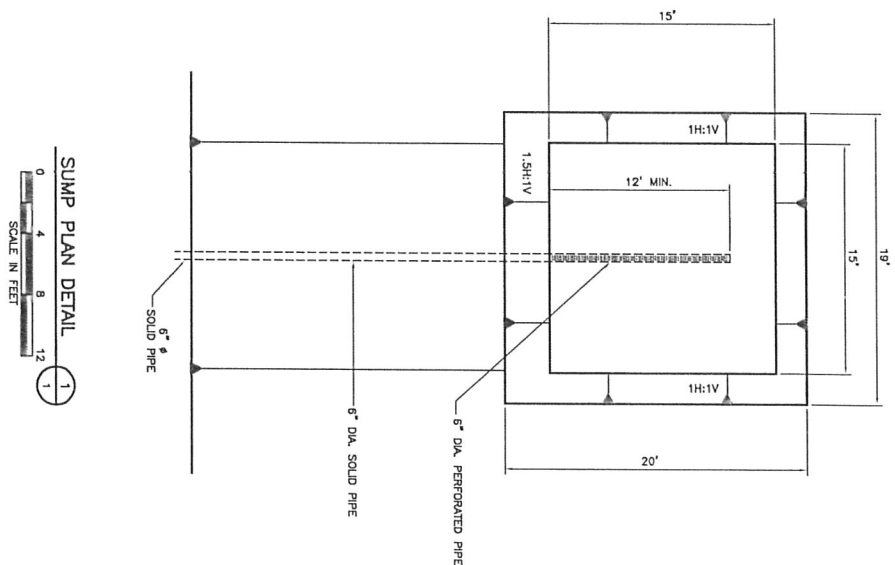
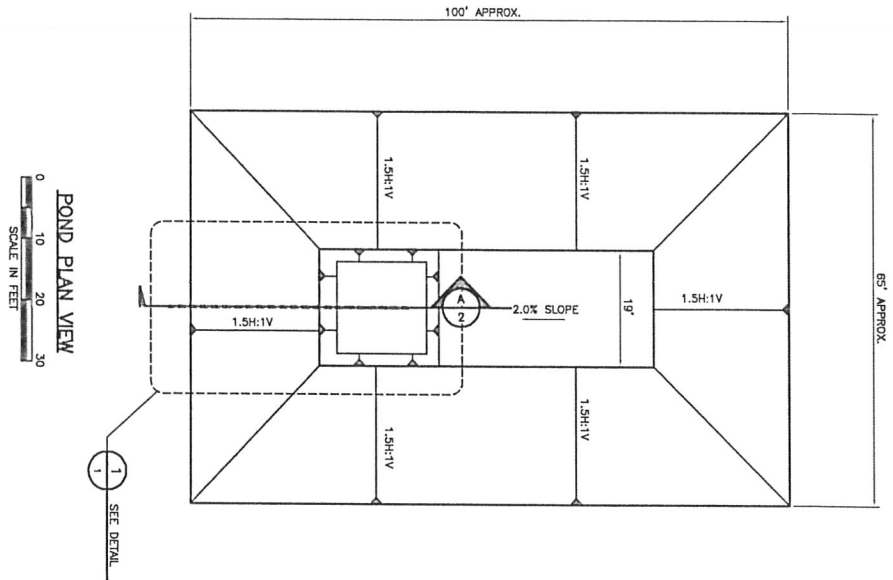

PRELIMINARY DESIGN

01
SHEET 1 OF 2

PRODUCED WATER
POND AND SUMP
PLAN

ISSUED FOR BIDDING	_____	DATE	_____
ISSUED FOR CONSTRUCTION			
_____	DATE	_____	_____
REVISIONS			
NO.	DESCRIPTION	DATE	
1.	PRELIMINARY DESIGN	3/17/09	
2.			
3.			
4.			
5.			
6.			
7.			
8.			
9.			
10.			
11.			
12.			
13.			
14.			
15.			
16.			
17.			
18.			
19.			
20.			
21.			
22.			
23.			
24.			
25.			
26.			
27.			
28.			
29.			
30.			
31.			
32.			
33.			
34.			
35.			
36.			
37.			
38.			
39.			
40.			
41.			
42.			
43.			
44.			
45.			
46.			
47.			
48.			
49.			
50.			
51.			
52.			
53.			
54.			
55.			
56.			
57.			
58.			
59.			
60.			
61.			
62.			
63.			
64.			
65.			
66.			
67.			
68.			
69.			
70.			
71.			
72.			
73.			
74.			
75.			
76.			
77.			
78.			
79.			
80.			
81.			
82.			
83.			
84.			
85.			
86.			
87.			
88.			
89.			
90.			
91.			
92.			
93.			
94.			
95.			
96.			
97.			
98.			
99.			
100.			
DESIGNED BY	2240346-00000	CHECKED BY	WAG
DATE CREATED	03/13/09	PLAT DATE	3/18/2009
SCALE	AS SHOWN	ACAD VER.	17.15 (LWS TECH)
SHEET TITLE			

PRODUCED WATER
POND LEAK
DETECTION SYSTEM

noble
energy

URSS
713 South Loop East
Greensboro, NC 27401
970-384-4731 (phone)
970-440-9788 (fax)

