

Scan. No.



02032633

COGCC 2

UNGRADED ELEVATION: 6538.9'
 FINISHED ELEVATION: 6536.8'
 APPROX. DISTURBANCE: 5.5± ACRES

LOCATION DRAWING

RECEIVED

OCT 22 2009

COGCC/Rifle Office

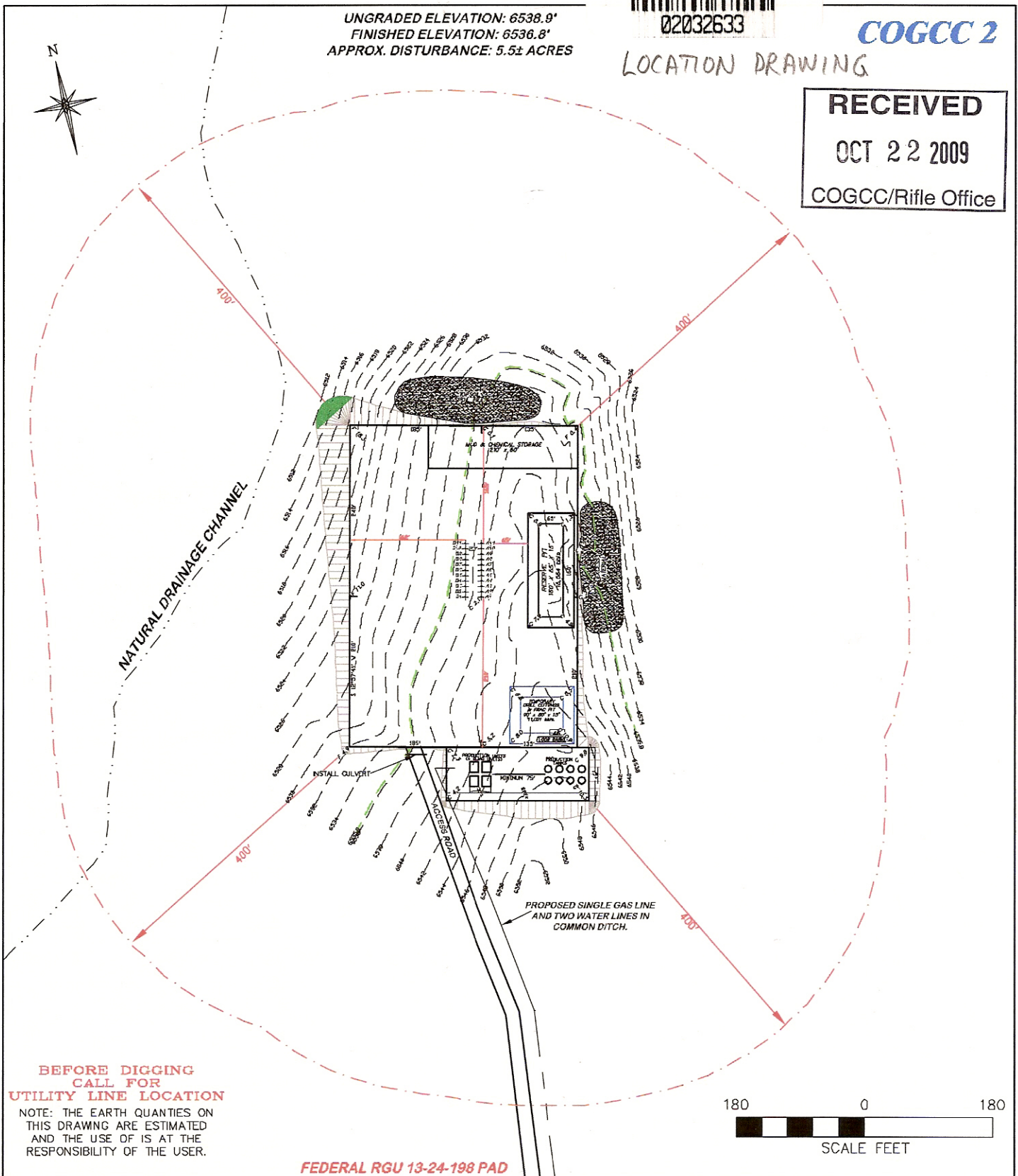

RIFFIN & ASSOCIATES, INC.

(307) 362-5028

1414 ELK ST., ROCK SPRINGS, WY 82901

DRAWN: 8/5/09 - MMM

SCALE: 1" = 180'

REVISED: 10/22/09 - MMM

DRG JOB No. 17149

ADDED PIPELINE NOTE

EXHIBIT 2D

LOCATION DRAWING

WILLIAMS PRODUCTION RMT COMPANY
**FEDERAL RGU 13-, -24, -423-, 23-, 422-, 14-, 413-,
 412-24-198**

UNGRADED ELEVATION: 6538.9'
 FINISHED ELEVATION: 6536.8'