

State of Colorado
Oil and Gas Conservation Commission

1120 Lincoln Street, Suite 801, Denver, Colorado 80203 (303) 894-2100 Fax 894-2109



FOR OGCC USE ONLY

Former AMOCO SITE

REMEDIATION 4353

SITE INVESTIGATION AND REMEDIATION WORKPLAN

This form shall be submitted to the Director for approval prior to the initiation of site investigation and remediation activities. Form 27 is intended to be used whenever possible. Additional documentation will be required when large volumes of soil and groundwater have been impacted or involve large facilities with multiple source areas. See Rule 910. Attach as many pages as needed to fully describe the proposed work.

CAUSE OF CONDITION BEING INVESTIGATED AND REMEDIATED

☐ Spill or Release ☐ Plug & Abandon ☐ Central Facility Closure ☐ Site/Facility Closure ☒ Other (describe): NFA

OGCC Employee:

☐ Spill ☐ Complaint
☐ Inspection ☐ NOAV

Tracking No: 1984454

GENERAL INFORMATION

OGCC Operator Number: 47120		Contact Name and Telephone	
Name of Operator: Kerr-McGee Oil & Gas Onshore LP		Name: Paul Schneider	
Address: 1099 18th Street, Suite 1800		No: 720-929-6000	
City: Denver State: CO Zip: 80202		Fax: 720-929-7726	
API/Facility No: 05-123-07924		County: Weld	
Facility Name: Norgren Donald C #1		Facility Number:	
Well Name: Norgren Donald C #1		Well Number:	
Location (QtrQtr, Sec, Twp, Rng, Meridian): SWNE 14-T3N-R67W 6th		Latitude: Longitude:	

TECHNICAL CONDITIONS

Type of Waste Causing Impact (crude oil, condensate, produced water, etc.): Oil and Produced Water		
Site Conditions: Is location within a sensitive area (according to Rule 901e)? <input checked="" type="checkbox"/> Y <input type="checkbox"/> N If yes, attach evaluation. Groundwater < 20 ft.		
Adjacent land use (cultivated, irrigated, dry land farming, industrial, residential, etc.): Rangeland		
Soil type, if not previously identified on Form 2A or Federal Surface Use Plan: See attached boring logs		
Potential receptors (water wells within 1/4 mi, surface waters, etc.): South Platte River approximately 60' west of the site, water well approximately 650' south of the site and groundwater at approximately 4' bgs.		
Description of Impact (if previously provided, refer to that form or document):		
Impacted Media (check):	Extent of Impact:	How Determined:
<input checked="" type="checkbox"/> Soils	Soil not impacted	Soil samples for field screening and laboratory analysis
<input type="checkbox"/> Vegetation		
<input checked="" type="checkbox"/> Groundwater	Groundwater not impacted	Collected groundwater samples for laboratory analysis
<input type="checkbox"/> Surface water		

REMEDIAL ACTION WORKPLAN

Describe initial action taken (if previously provided, refer to that form or document): Based on data collected by the previous operator of this facility (Amoco), COGCC requested that Kerr-McGee conduct additional subsurface assessment activities at this tank battery to determine the extent and magnitude of any potential historic soil and/or groundwater petroleum hydrocarbon impacts.
Describe how source is to be removed: Assessment activities at this site included the continuous sampling of two boreholes (SB01 and SB02) at the tank battery using a truck-mounted Geoprobe. The borehole locations were selected based on where any potential impacts were most likely to be detected. One soil sample per borehole was collected above the water table from the soil interval exhibiting the highest photo-ionization detector (PID) headspace reading. Soil samples were submitted for Total Petroleum Hydrocarbons (TPH) analysis by EPA Method 8015 (Full Carbon Chain, C6-C36). Soil sample analytical results indicate that TPH concentrations are below the COGCC 1,000 milligrams per kilogram (mg/kg) sensitive area allowable level in the SB01 and SB02 soil samples. Each borehole was completed as a groundwater monitoring well (MW01 and MW02).
Describe how remediation of existing impacts is to be accomplished, including removal and disposal at an injection well or licensed facility, land treatment on site, removal of impacted groundwater, insitu bioremediation, burning of oily vegetation, etc.: Not applicable

State of Colorado
Oil and Gas Conservation Commission

1120 Lincoln Street, Suite 801, Denver, Colorado
(303) 894-2100 Fax 894-2109



Tracking Number:	_____
Name of Operator:	<u>Kerr-McGee Oil & Gas Onshore LP</u>
OGCC Operator No:	<u>47120</u>
Received Date:	_____
Well Name & No:	<u>Norgren Donald C #1</u>
Facility Name & No.:	<u>Norgren Donald C #1</u>

REMEDIATION WORKPLAN (CONT.)

OGCC Employee: _____

If groundwater has been impacted, describe proposed monitoring plan (# of wells or sample points, sampling schedule, analytical methods, etc.):

Two monitoring wells (AMW01 and AMW02) existed at the site and two additional monitoring wells (MW01 and MW02) were installed and sampled in April 2008 for BTEX analysis by EPA Method 8260B. Monitoring well AMW02 was dry during the April 2008 sampling event and BTEX concentrations were below the CGWQS in monitoring wells AMW01, MW01 and MW02.

Describe reclamation plan. Discuss existing and new grade recontouring; method and testing of compaction alleviation; and reseeding program, including location of new seed, seed mix and noxious weed prevention. Attach diagram or drawing. Use additional sheet for description if required.

Kerr-McGee's production facility remains at the site.

Attach samples and analytical results taken to verify remediation of impacts. Show locations of samples on an onsite schematic or drawing.

Is further site investigation required? ☐ Y ☒ N If yes, describe:

Soil sample analytical results indicate that TPH concentrations are below the COGCC 1,000 mg/kg sensitive area allowable level in the samples collected from boreholes SB01 and SB02. Groundwater sample analytical results indicate that BTEX concentrations are below the CGWQS in monitoring wells AMW01, MW01 and MW02. Based on the analytical results, Kerr-McGee is requesting NFA status for this site.

Final disposition of E&P waste (landtreated and disposed onsite, name of licensed disposal facility, recycling, reuse, etc.):

Not applicable

IMPLEMENTATION SCHEDULE

Date Site Investigation Began:	<u>4/9/08</u>	Date Site Investigation Completed:	<u>Active</u>	Remediation Plan Submitted:	_____
Remediation Start Date:	<u>4/9/08</u>	Anticipated Completion Date:	<u>12/31/08</u>	Actual Completion Date:	_____

I hereby certify that the statements made in this form are, to the best of my knowledge, true, correct, and complete.

Print Name: Paul D. Schneider

Signed: _____ Title: Staff Environmental & Regulatory Analyst Date: _____

OGCC Approved: _____ Title: _____ Date: _____

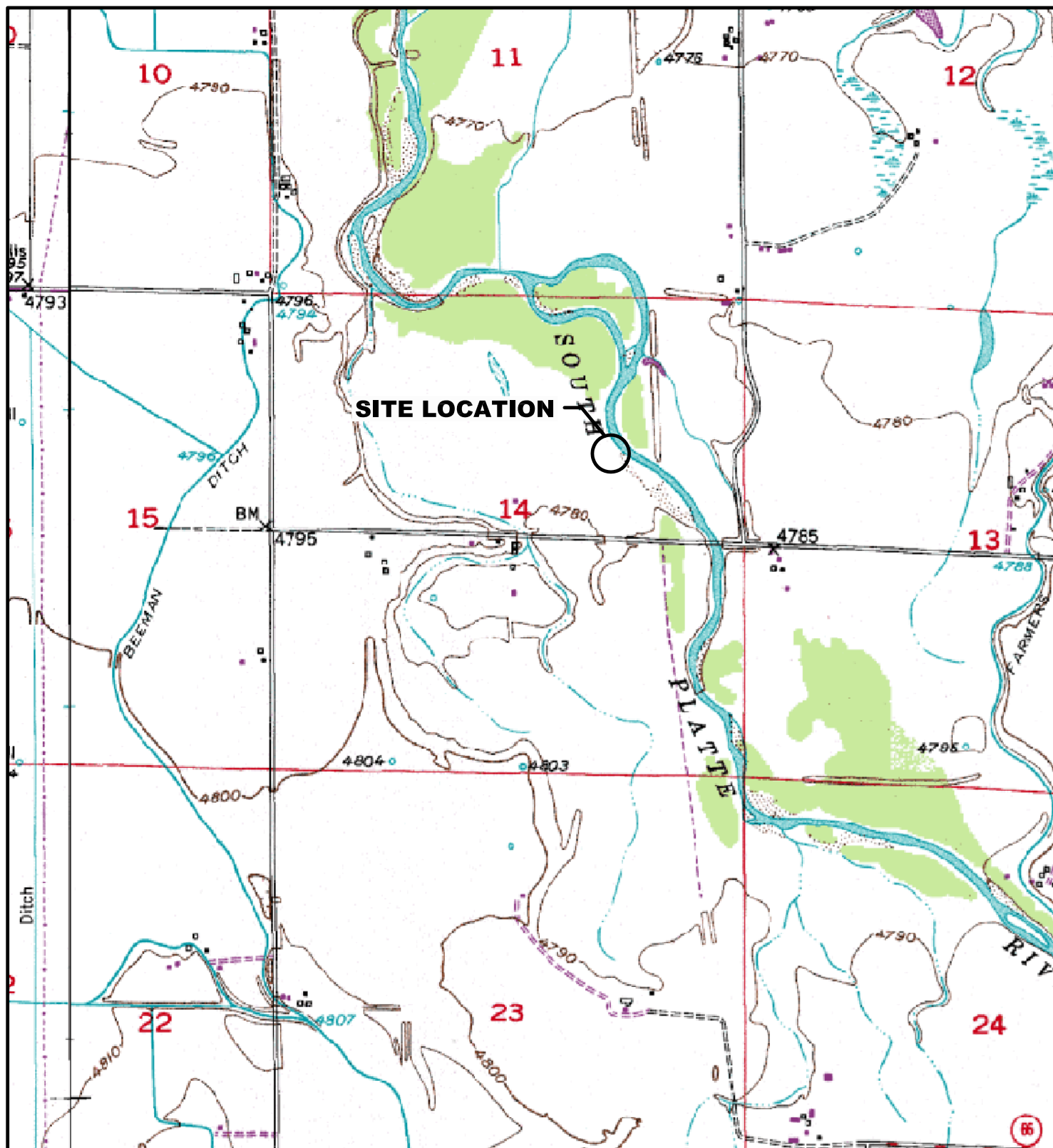

LEGEND

○ SITE LOCATION



0 375 750 1500
FEET

FIGURE 1
SITE LOCATION MAP
NORGREN DONALD C #1
SWNE 14-T3N-R67W
WELD COUNTY, CO
KERR-McGEE OIL & GAS ONSHORE LP

SOURCE: TOPOZONE.COM
USGS 7.5' QUADRANGLE
(NAD27)



KMG0513202_SL 8/08

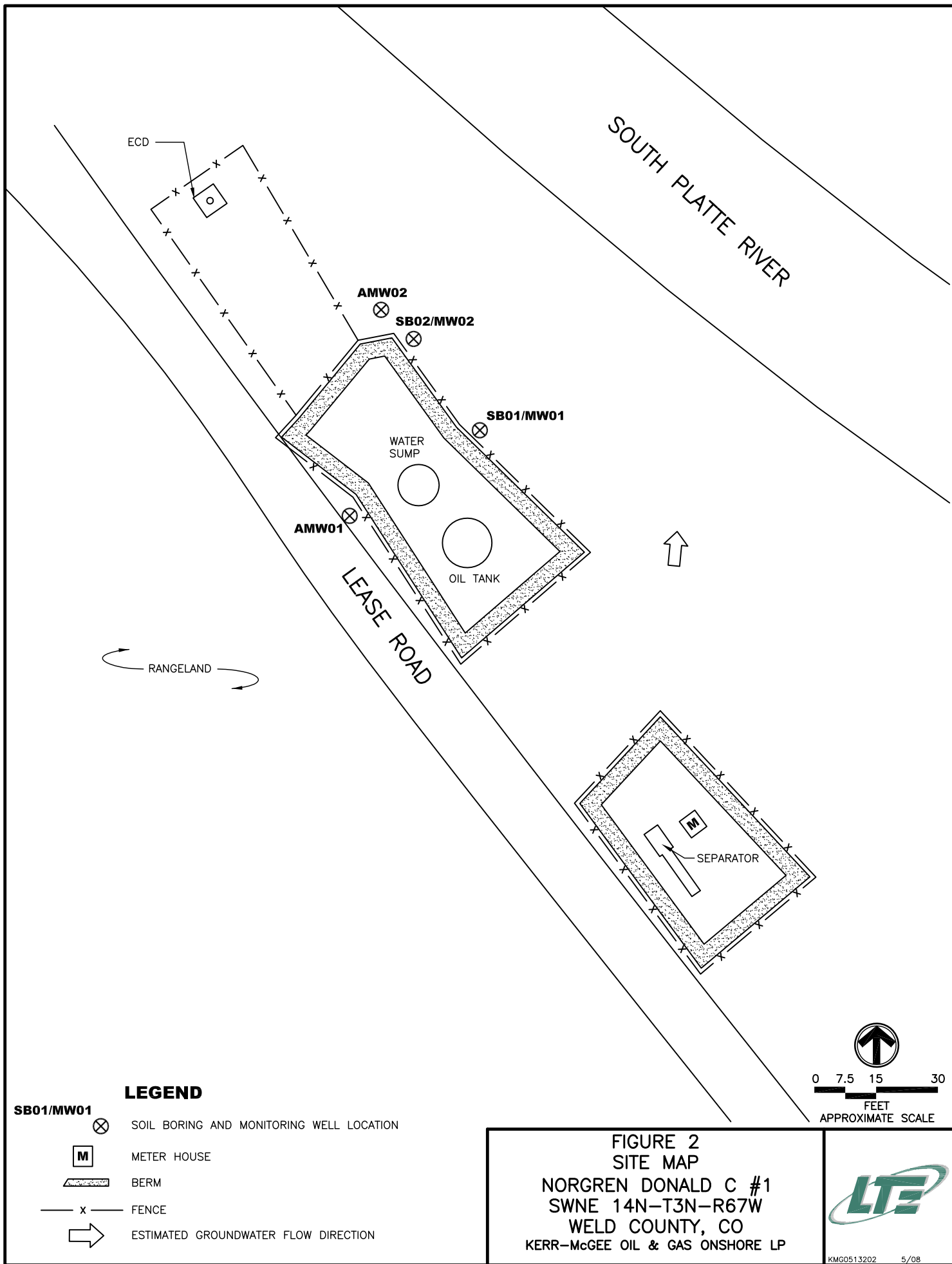

TABLE 1
SOIL BORING ANALYTICAL RESULTS
NORGREN DONALD C 1
KERR-McGEE OIL & GAS ONSHORE LP

Sample Location (Depth in feet)	Date	TEPH (mg/kg)
SB01 (4-5)	04/09/2008	490
SB02 (5-6)	04/09/2008	300

COGCC Standards

1000

Notes: TEPH - Total Extractable Petroleum Hydrocarbons
 < - less than NA - Not Analyzed/Not Available
 COGCC - Colorado Oil and Gas Conservation Commission

Bold numbers indicate result equaled or exceeded standard.
 mg/kg - milligrams per kilogram



TABLE 2
GROUNDWATER ANALYTICAL AND FIELD RESULTS
NORGREN DONALD C 1
KERR-McGEE OIL & GAS ONSHORE LP

Well Name	Date	Benzene (ug/L)	Toluene (ug/L)	Ethylbenzene (ug/L)	Xylenes (ug/L)	Depth Water/ (Depth Product) (ft bgs)
AMW01	04/30/2008	<1.0	<1.0	<1.0	<1.0	3.57
AMW02	04/30/2008	Dry - Not Sampled				Dry
MW01	04/30/2008	<1.0	<1.0	<1.0	<1.0	4.00
MW02	04/30/2008	<1.0	<1.0	1.1	15	3.80
Colo GW Quality Standards		5	1000	700	1400	

Notes: < - less than

ug/L - micrograms per Liter

NA - Not Analyzed/Not Available

GW - Groundwater

Bold numbers indicate result equaled or exceeded standard.

ND - Not Detected

NM - Not Measured

ft bgs - feet below ground surface



Summit Scientific

741 Corporate Circle – Suite I ♦ Golden, Colorado 80401

303.277.9310 - laboratory ♦ 303.374.5933 - fax

April 14, 2008

Mike Unger

LT Environmental, Inc.

4600 West 60th Avenue

Arvada, CO 80003

RE: KMG - Norgren Donald C #1

Enclosed are the results of analyses for samples received by Summit Scientific on 04/10/08 07:30. If you have any questions concerning this report, please feel free to contact me.

Sincerely,

A handwritten signature in black ink, appearing to be 'BS' or 'Shrewsbury', with a long, sweeping horizontal line extending to the right.

Ben Shrewsbury

Vice President / Laboratory Director



LT Environmental, Inc.
4600 West 60th Avenue
Arvada CO, 80003

Project: KMG - Norgren Donald C #1

Project Number: KMG 05132
Project Manager: Mike Unger

Reported:
04/14/08 15:33

ANALYTICAL REPORT FOR SAMPLES

Sample ID	Laboratory ID	Matrix	Date Sampled	Date Received
SB01@4-5'	R804059-01	Soil	04/09/08 12:15	04/10/08 07:30
SB02@5-6'	R804059-02	Soil	04/09/08 12:40	04/10/08 07:30

Summit Scientific

The results in this report apply to the samples analyzed in accordance with the chain of custody document. This analytical report must be reproduced in its entirety.



LT Environmental, Inc.
4600 West 60th Avenue
Arvada CO, 80003

Project: KMG - Norgren Donald C #1

Project Number: KMG 05132
Project Manager: Mike Unger

Reported:
04/14/08 15:33

SB01@4-5'
R804059-01 (Soil)

Summit Scientific

Extractable Petroleum Hydrocarbons by 8015

Date Sampled: **04/09/08 12:15**

Analyte	Result	Reporting Limit	Units	Dilution	Batch	Prepared	Analyzed	Method	Notes
C6-C10 (TEPH-GRO)	290	50	mg/kg	1	8041106	04/11/08	04/12/08	8015 Full Carbon Chain	
C10-C28 (TEPH-DRO)	200	50	"	"	"	"	"	"	
C28-C36 (TEPH-ORO)	ND	50	"	"	"	"	"	"	

Date Sampled: **04/09/08 12:15**

Analyte	Result	Reporting Limit	Units	Dilution	Batch	Prepared	Analyzed	Method	Notes
<i>Surrogate: o-Terphenyl</i>		85.2 %	70-130		"	"	"	"	
<i>Surrogate: Trifluorotoluene</i>		85.2 %	70-130		"	"	"	"	

Date Sampled: **04/09/08 12:15**

Analyte	Result	Reporting Limit	Units	Dilution	Batch	Prepared	Analyzed	Method	Notes
C6-C36 Total TEPH	490		"	"	[CALC]	"	"	EPA 8015	

Summit Scientific

The results in this report apply to the samples analyzed in accordance with the chain of custody document. This analytical report must be reproduced in its entirety.



LT Environmental, Inc.
4600 West 60th Avenue
Arvada CO, 80003

Project: KMG - Norgren Donald C #1

Project Number: KMG 05132
Project Manager: Mike Unger

Reported:
04/14/08 15:33

SB02@5-6'
R804059-02 (Soil)

Summit Scientific

Extractable Petroleum Hydrocarbons by 8015

Date Sampled: **04/09/08 12:40**

Analyte	Result	Reporting Limit	Units	Dilution	Batch	Prepared	Analyzed	Method	Notes
C6-C10 (TEPH-GRO)	160	50	mg/kg	1	8041106	04/11/08	04/12/08	8015 Full Carbon Chain	
C10-C28 (TEPH-DRO)	140	50	"	"	"	"	"	"	
C28-C36 (TEPH-ORO)	ND	50	"	"	"	"	"	"	

Date Sampled: **04/09/08 12:40**

Analyte	Result	Reporting Limit	Units	Dilution	Batch	Prepared	Analyzed	Method	Notes
Surrogate: <i>o</i> -Terphenyl		84.8 %	70-130		"	"	"	"	
Surrogate: Trifluorotoluene		82.9 %	70-130		"	"	"	"	

Date Sampled: **04/09/08 12:40**

Analyte	Result	Reporting Limit	Units	Dilution	Batch	Prepared	Analyzed	Method	Notes
C6-C36 Total TEPH	300		"	"	[CALC]	"	"	EPA 8015	

Summit Scientific

The results in this report apply to the samples analyzed in accordance with the chain of custody document. This analytical report must be reproduced in its entirety.



LT Environmental, Inc.
4600 West 60th Avenue
Arvada CO, 80003

Project: KMG - Norgren Donald C #1

Project Number: KMG 05132
Project Manager: Mike Unger

Reported:
04/14/08 15:33

Extractable Petroleum Hydrocarbons by 8015 - Quality Control

Summit Scientific

Analyte	Reporting			Spike	Source		%REC		RPD	
	Result	Limit	Units	Level	Result	%REC	Limits	RPD	Limit	Notes

Batch 8041106 - EPA 3550A

Blank (8041106-BLK1)

Prepared: 04/11/08 Analyzed: 04/12/08

C6-C10 (TEPH-GRO)	ND	50	mg/kg
C10-C28 (TEPH-DRO)	ND	50	"
C28-C36 (TEPH-ORO)	ND	50	"

Surrogate: o-Terphenyl	55.3	"	50.0	111	70-130
Surrogate: Trifluorotoluene	104	"	100	104	70-130

LCS (8041106-BS1)

Prepared: 04/11/08 Analyzed: 04/12/08

C10-C28 (TEPH-DRO)	567	50	mg/kg	500	113	65.3-142
Surrogate: o-Terphenyl	51.2		"	0.470	NR	70-130
Surrogate: Trifluorotoluene	98.8		"	0.940	NR	70-130

LCS Dup (8041106-BSD1)

Prepared: 04/11/08 Analyzed: 04/12/08

C10-C28 (TEPH-DRO)	586	50	mg/kg	500	117	65.3-142	3.30	19.7
Surrogate: o-Terphenyl	49.4		"	0.470	NR	70-130		
Surrogate: Trifluorotoluene	96.1		"	0.940	NR	70-130		

Matrix Spike (8041106-MS1)

Source: R804059-01

Prepared: 04/11/08 Analyzed: 04/12/08

C10-C28 (TEPH-DRO)	744	50	mg/kg	500	200	109	55.2-139
Surrogate: o-Terphenyl	48.1		"	0.470		NR	70-130
Surrogate: Trifluorotoluene	97.0		"	0.940		NR	70-130

Matrix Spike Dup (8041106-MSD1)

Source: R804059-01

Prepared: 04/11/08 Analyzed: 04/12/08

C10-C28 (TEPH-DRO)	999	50	mg/kg	500	200	160	55.2-139	29.3	16.7
Surrogate: o-Terphenyl	56.9		"	0.470		NR	70-130		
Surrogate: Trifluorotoluene	112		"	0.940		NR	70-130		

Summit Scientific

The results in this report apply to the samples analyzed in accordance with the chain of custody document. This analytical report must be reproduced in its entirety.



LT Environmental, Inc.
4600 West 60th Avenue
Arvada CO, 80003

Project: KMG - Norgren Donald C #1

Project Number: KMG 05132
Project Manager: Mike Unger

Reported:
04/14/08 15:33

Notes and Definitions

DET Analyte DETECTED
ND Analyte NOT DETECTED at or above the reporting limit
NR Not Reported
dry Sample results reported on a dry weight basis
RPD Relative Percent Difference

Summit Scientific

The results in this report apply to the samples analyzed in accordance with the chain of custody document. This analytical report must be reproduced in its entirety.

A handwritten signature in black ink, appearing to be 'JMM'.

Summit Scientific

741 Corporate Circle – Suite I ♦ Golden, Colorado 80401

303.277.9310 - laboratory ♦ 303.277.9531 - fax

May 07, 2008

Mike Unger

LT Environmental, Inc.

4600 West 60th Avenue

Arvada, CO 80003

RE: KMG - Norgren Donald C #1

Enclosed are the results of analyses for samples received by Summit Scientific on 04/30/08 17:40. If you have any questions concerning this report, please feel free to contact me.

Sincerely,

A handwritten signature in black ink, appearing to be 'BS' or 'Shrewsbury', with a long, sweeping horizontal line extending to the right.

Ben Shrewsbury

Vice President / Laboratory Director



LT Environmental, Inc.
4600 West 60th Avenue
Arvada CO, 80003

Project: KMG - Norgren Donald C #1

Project Number: KMG 05132
Project Manager: Mike Unger

Reported:
05/07/08 16:13

ANALYTICAL REPORT FOR SAMPLES

Sample ID	Laboratory ID	Matrix	Date Sampled	Date Received
AMW01	R805002-01	Water	04/30/08 14:20	04/30/08 17:40
MW01	R805002-02	Water	04/30/08 14:40	04/30/08 17:40
MW02	R805002-03	Water	04/30/08 14:50	04/30/08 17:40

Summit Scientific

The results in this report apply to the samples analyzed in accordance with the chain of custody document. This analytical report must be reproduced in its entirety.

LT Environmental, Inc.
4600 West 60th Avenue
Arvada CO, 80003

Project: KMG - Norgren Donald C #1

Project Number: KMG 05132
Project Manager: Mike Unger

Reported:
05/07/08 16:13

Summit Scientific
R905002

52

741 Corporate Circle Suite I ♦ Golden, Colorado 80401
303-277-9310 ♦ 303-277-9531 Fax

Page / of

Client: LT Environmental, Inc.

Address: 4600 West 60th Avenue

City/State/Zip: Arvada, CO 80003

Phone: (303) 433-9788, Fax: (303) 433-1432

Sampler Name: Bob Davis

Carroll

Client: LT Environmental, Inc.
Address: 4600 West 60th Avenue
Project Manager: John Cocroft

City/State/Zip: Arvada, CO 80003
E-Mail: icocroft@ltnv.com

Phone: (303) 433-9788	Fax: (303) 433-1432	Project Name: NORRIS	WALSH
-----------------------	---------------------	----------------------	-------

Sampler Name:	AKC	Project Number:	200512901
---------------	-----	-----------------	-----------

[illegible][illegible]

www.s2scientific.com

Summit Scientific

The results in this report apply to the samples analyzed in accordance with the chain of custody document. This analytical report must be reproduced in its entirety.



LT Environmental, Inc.
4600 West 60th Avenue
Arvada CO, 80003

Project: KMG - Norgren Donald C #1

Project Number: KMG 05132
Project Manager: Mike Unger

Reported:
05/07/08 16:13

AMW01
R805002-01 (Water)

Summit Scientific

Volatile Organic Compounds by EPA Method 8260B

Date Sampled: **04/30/08 14:20**

Analyte	Result	Reporting Limit	Units	Dilution	Batch	Prepared	Analyzed	Method	Notes
Benzene	ND	1.0	ug/l	1	8050204	05/02/08	05/05/08	EPA 8260B	
Toluene	ND	1.0	"	"	"	"	"	"	
Ethylbenzene	ND	1.0	"	"	"	"	"	"	
Xylenes (total)	ND	1.0	"	"	"	"	"	"	

Date Sampled: **04/30/08 14:20**

Analyte	Result	Reporting Limit	Units	Dilution	Batch	Prepared	Analyzed	Method	Notes
Surrogate: 1,2-Dichloroethane-d4		118 %	90.2-124		"	"	"	"	
Surrogate: Toluene-d8		100 %	92.1-106		"	"	"	"	
Surrogate: 4-Bromofluorobenzene		102 %	84.5-110		"	"	"	"	

Summit Scientific

The results in this report apply to the samples analyzed in accordance with the chain of custody document. This analytical report must be reproduced in its entirety.



LT Environmental, Inc.
4600 West 60th Avenue
Arvada CO, 80003

Project: KMG - Norgren Donald C #1
Project Number: KMG 05132
Project Manager: Mike Unger

Reported:
05/07/08 16:13

MW01
R805002-02 (Water)

Summit Scientific

Volatile Organic Compounds by EPA Method 8260B

Date Sampled: **04/30/08 14:40**

Analyte	Result	Reporting		Dilution	Batch	Prepared	Analyzed	Method	Notes
		Limit	Units						
Benzene	ND	1.0	ug/l	1	8050204	05/02/08	05/05/08	EPA 8260B	
Toluene	ND	1.0	"	"	"	"	"	"	
Ethylbenzene	ND	1.0	"	"	"	"	"	"	
Xylenes (total)	ND	1.0	"	"	"	"	"	"	

Date Sampled: **04/30/08 14:40**

Analyte	Result	Reporting		Dilution	Batch	Prepared	Analyzed	Method	Notes
		Limit	Units						
Surrogate: 1,2-Dichloroethane-d4		72.4 %	90.2-124		"	"	"	"	S-04
Surrogate: Toluene-d8		101 %	92.1-106		"	"	"	"	
Surrogate: 4-Bromofluorobenzene		85.7 %	84.5-110		"	"	"	"	

Summit Scientific

The results in this report apply to the samples analyzed in accordance with the chain of custody document. This analytical report must be reproduced in its entirety.



LT Environmental, Inc.
4600 West 60th Avenue
Arvada CO, 80003

Project: KMG - Norgren Donald C #1
Project Number: KMG 05132
Project Manager: Mike Unger

Reported:
05/07/08 16:13

MW02
R805002-03 (Water)

Summit Scientific

Volatile Organic Compounds by EPA Method 8260B

Date Sampled: **04/30/08 14:50**

Analyte	Result	Reporting Limit	Units	Dilution	Batch	Prepared	Analyzed	Method	Notes
Benzene	ND	1.0	ug/l	1	8050204	05/02/08	05/05/08	EPA 8260B	
Toluene	ND	1.0	"	"	"	"	"	"	
Ethylbenzene	1.1	1.0	"	"	"	"	"	"	
Xylenes (total)	15	1.0	"	"	"	"	"	"	

Date Sampled: **04/30/08 14:50**

Analyte	Result	Reporting Limit	Units	Dilution	Batch	Prepared	Analyzed	Method	Notes
Surrogate: 1,2-Dichloroethane-d4		69.0 %	90.2-124		"	"	"	"	S-04
Surrogate: Toluene-d8		95.5 %	92.1-106		"	"	"	"	
Surrogate: 4-Bromofluorobenzene		99.2 %	84.5-110		"	"	"	"	

Summit Scientific

The results in this report apply to the samples analyzed in accordance with the chain of custody document. This analytical report must be reproduced in its entirety.



LT Environmental, Inc.
4600 West 60th Avenue
Arvada CO, 80003

Project: KMG - Norgren Donald C #1
Project Number: KMG 05132
Project Manager: Mike Unger

Reported:
05/07/08 16:13

Volatile Organic Compounds by EPA Method 8260B - Quality Control

Summit Scientific

Analyte	Reporting			Spike	Source		%REC		RPD	
	Result	Limit	Units	Level	Result	%REC	Limits	RPD	Limit	Notes

Batch 8050204 - EPA 5030 Water MS

Blank (8050204-BLK1)

Prepared: 05/02/08 Analyzed: 05/05/08

Benzene	ND	1.0	ug/l							
Toluene	ND	1.0	"							
Ethylbenzene	ND	1.0	"							
Xylenes (total)	ND	1.0	"							
Surrogate: 1,2-Dichloroethane-d4	9.02		"	13.3	67.8	90.2-124				
Surrogate: Toluene-d8	12.0		"	13.3	90.2	92.1-106				
Surrogate: 4-Bromofluorobenzene	11.8		"	13.3	88.7	84.5-110				

LCS (8050204-BS1)

Prepared: 05/02/08 Analyzed: 05/05/08

Benzene	22.2	1.0	ug/l	33.3	66.7	61.4-110				
Toluene	26.7	1.0	"	33.3	80.2	54.2-116				
Surrogate: 1,2-Dichloroethane-d4	9.30		"	13.3	69.9	90.2-124				
Surrogate: Toluene-d8	12.6		"	13.3	94.7	92.1-106				
Surrogate: 4-Bromofluorobenzene	12.5		"	13.3	94.0	84.5-110				

LCS Dup (8050204-BSD1)

Prepared: 05/02/08 Analyzed: 05/05/08

Benzene	21.7	1.0	ug/l	33.3	65.2	61.4-110	2.28	11.8		
Toluene	26.6	1.0	"	33.3	79.9	54.2-116	0.375	12.2		
Surrogate: 1,2-Dichloroethane-d4	8.23		"	13.3	61.9	90.2-124				
Surrogate: Toluene-d8	12.1		"	13.3	91.0	92.1-106				
Surrogate: 4-Bromofluorobenzene	12.5		"	13.3	94.0	84.5-110				

Summit Scientific

The results in this report apply to the samples analyzed in accordance with the chain of custody document. This analytical report must be reproduced in its entirety.



LT Environmental, Inc.
4600 West 60th Avenue
Arvada CO, 80003

Project: KMG - Norgren Donald C #1

Project Number: KMG 05132
Project Manager: Mike Unger

Reported:
05/07/08 16:13

Notes and Definitions

S-04 The surrogate recovery for this sample is outside of established control limits due to a sample matrix effect.

DET Analyte DETECTED

ND Analyte NOT DETECTED at or above the reporting limit

NR Not Reported

dry Sample results reported on a dry weight basis

RPD Relative Percent Difference

Summit Scientific

The results in this report apply to the samples analyzed in accordance with the chain of custody document. This analytical report must be reproduced in its entirety.

A handwritten signature in black ink, appearing to be 'JMM'.