



01408831

1R-105

Reports and Diagrams

History of

**Natural Gas Volume Measurement and Reporting Yuma County  
Colorado**

To be presented to:

The State of Colorado

Colorado Oil & Gas Conservation Commission

Monday, March 31, 2008

Compiled by:

Mary Lou Brophy  
36611 Co. Rd. FF  
Wray, CO 80758  
Phone: 970-332-4157

## Introduction

**Premise:** In order to rewrite the rules for gas measurement, reconciliation and reporting we must look at current and historic practices. These reports and diagrams show inconsistencies in volume reporting and reconciliation.

In April 1974 Desmond Brophy and two of his brothers entered a contract by which they sold all the gas and oil from almost 8000 acres. They were to be paid 1/8 of the proceeds from all the gas produced and sold as it was produced over time.

Royalty payments are calculated by multiplying the volume times the price times the percentage. Thereby the volume reported and sold are basic to accurate calculation of payments.

In 1996 several Brophy's were litigants in the Rogers vs. Westerman Farms Case. At the time they entered that case, Mary Lou Brophy started recording and summarizing royalty payments. The records are complete from 1992 to date. Royalty remittance statements are on file as entered in the computer and are available for your examination.

With the exception of the location of gathering lines, compressors and volumes from remittance statements, all facts in this presentation can be verified in the production records, documents and library at the COGCC website. The records locating compressor sites and Certificates of Clearance (which are the records of well operators and gathering companies) are not up to date and complete.

## **Natural Gas Volume Measuring and Reporting Yuma County, Colorado**

### **Table of Contents:**

1. COGCC GIS Map adding Gathering Systems on Brophy Brothers Ranch lease.
2. Gathering Facts: Spreadsheet Summary of Production Reporting Sections 1 & 6, calculating percentage reported sold.
  - a. Rosewood Operating, Yuma Gathering, Gathering, Sections 1 & 6 (100% Federal Interest): No gas Shrinkage.
  - b. Berry Petroleum Operating, Yuma Gathering, Gathering: Gas Shrinkage
  - c. Berry Petroleum Operating, Bitter Creek Gathering
    - i. Federal interest: 97+% sold
    - ii. No Federal interest: About 95.5% sold
  - d. Stelbar Operating, Bitter Creek Gathering: No gas flared, used or shrinkage.
3. Pictures: one meter shed in Section 21 where gas from three wells in 21 and one in 16 are metered and merged to the Bitter Creek gathering line that gathers gas from sections 17, 18, 19, 20 and 21 in 4N45W and 13 and 24 in 4N46W (plus gas from other leases).
4. Comparison total gas produced and sold 2006 with percentage sold from each well grouped by Gathering Company. Percentages sold from each well show preferential treatment for Government mineral owners.
5. Volume Comparison. Royalty payments are computed by multiplying the volume by the price times the percentage.
  - a. The three columns on the left are volumes produced and sold as reported to Colorado Oil & Gas Conservation Commission and the percentage reported sold for each month.
    - i. Note that until October of 2003 less than one percent was reported lost or used. Since then as much as 5.5% has been lost.
  - b. Royalties on this well are paid by 3 companies.
    - i. We get three remittance statements a month.
    - ii. The percentages paid by each company have to be added to get our total percentage.
    - iii. Volumes listed in the right hand columns are the volumes that are listed on remittance statements.
6. An Interesting Fact about Natural Gas Production in Yuma County Colorado:
  - a. Almost twice as much gas was lost, used, disappeared in 2006 as was produced in 2002.



Inside the blue lines there are 118 producing wells. wells that are gathered by Yuma Gathering are circled. All other wells are gathered by Bitter Creek. The three YGS Compressors are located outside the lease lines. Bitter Creek has one Compressor in the corner of Section 24. The other is in T5N R46W Section 35.

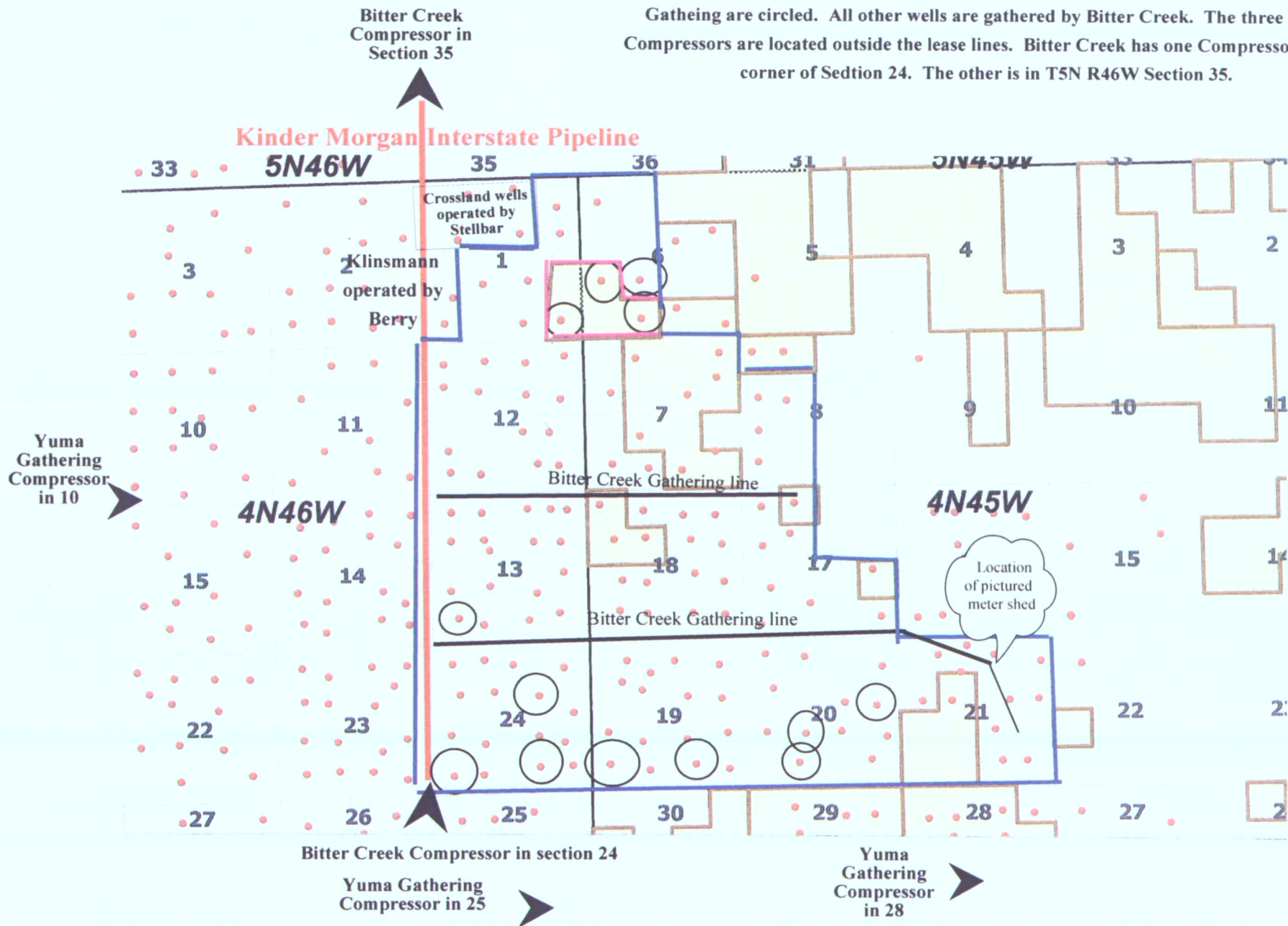

We own an interest in 115 of the 118 wells inside the blue lines. The Federal Government owns all the minerals in the three wells in sections 1 and 6 that are gathered by Yuma Gathering. We own an interest in the fourth well they gather in section 6. Gas from all four wells has to go into the same gathering system, The gas used & shrinkage is less from the government wells. The government also owns a percentage of 26 producing wells in Sections 7, 17, 18 and 21 gathered by Bitter Creek. Gas from these wells is commingled in the gathering lines with gas from 77 other wells on this property and wells on other property, including 3 wells on the State Section (16) and four wells on Crossland and Klinsman. There is less gas used and lost in the government wells.

## Wells, Companies and Volume Reporting

### PRODUCTION NOVEMBER 2007

#### Section 1, Range 4 North, Township 46 West

Yuma County API Sequence is 05-125 and well sequences as listed:

API									
Sequence	Well Name	Operated by	Gathered by	Produced	Used	Shrinkage	Sold	BTU	Percent Sold
09932	J. P. BROPHY 41-1	BERRY	BITTER CREEK	1462	75		1387	1000	94.87%
09866	KLINZMANN 13-1	BERRY	BITTER CREEK	1956	100		1856	1000	94.89%
09819	CROSSLAND 2-1	STELBAR	BITTER CREEK	2772			2772	978	100.00%
08769	CROSSLAND 1-1	STELBAR	BITTER CREEK	398			398	978	100.00%
08081	D. BROPHY 43-1	BERRY	BITTER CREEK	1615	82		1533	1000	94.92%
08043	D. BROPHY 37-1	BERRY	BITTER CREEK	1187	59		1128	1000	95.03%
07980	KLINZMAN 11-1	BERRY	BITTER CREEK	870	44		826	1000	94.94%
07610	D. BROPHY 22-1	BERRY	BITTER CREEK	1685	84		1601	1001	95.01%
07486	OBF 1	ROSEWOOD	YUMA GATHERING	1338	37		1301	996	97.23%

#### Section 6, Range 4 North, Township 45 West

09849	J.P. BROPHY 11-06	BERRY	BITTER CREEK	4198	214		3984	1000	94.90%
07741	D. BROPHY 29-6	BERRY	YUMA GATHERING	445	27	-17	435	1016	97.75%
07528	HSR-BROPHY/FEDERAL	ROSEWOOD	YUMA GATHERING	1177	32		1145	996	97.28%
07487	OBF 2	ROSEWOOD	YUMA GATHERING	703	19		684	996	97.30%

**Please note: this is not a normal month for wells gathered by Yuma Gathering. The gas usually shrinks. It does not grow often.**

There are 4 wells gathered by Yuma Gathering. There is no Shrinkage listed in 2007 for any well where the government owns an interest.

Gas from the other well gathered by Yuma shrinks every month.

Wells operated by Stelbar show no gas used or lost the entire year.

The rest of the wells leased from private citizens and gathered by Bitter Creek used about 5% every month.



South surface of the Well Shed identifying the 4 wells metered inside this shed. They are Brophy Bros 41-21 & 42-21, JP Brophy 21-21 and Brophy Bros-State 34-16.



East side of shed there are four dehydration tanks and 4 pipes entering the shed.





East side clear  
views of four  
pipes into the shed



West side:  
Clearly 4 pipes out  
of shed merge to one  
connection to the  
gathering line.



# WELL LIST BY PERCENT SOLD

28-March-2008

Over 95.7% is printed in Red

Gathered by Bitter Creek

11/01/2007	Section 06						
	API	Produced	Sold	Used	Shrinkage	Percent sold	USA Interest
JP BROPHY 11-06	09849	4198	3984	214		0.949023	
		4,198	3,984	214		0.949023	
11/01/2007	Section 07						
	API	Produced	Sold	Used	Shrinkage	Percent sold	USA Interest
T. BROPHY 21-07	06485	1038	997	41		0.960501	24.75247%
D. BROPHY 04-07	07283	871	843	28		0.967853	49.57858%
D. BROPHY 03-07	07284	1055	1028	27		0.974408	75.00000%
D. BROPHY 16-07	07504	943	920	23		0.975610	75.00000%
D. BROPHY 14-07	07506	656	636	20		0.969512	49.57858%
D. BROPHY 15-07	07507	424	412	12		0.971698	24.75240%
		4,987	4,836	151		0.969930	
11/01/2007	Section 08						
	API	Produced	Sold	Used	Shrinkage	Percent sold	USA Interest
JP BROPHY 13-08	09850	382	366	16		0.958115	
		382	366	16		0.958115	
11/01/2007	Section 17						
	API	Produced	Sold	Used	Shrinkage	Percent sold	USA Interest
T. BROPHY 11-17	06214	1354	1289	65		0.951994	12.50000%
D. BROPHY 06-17	07310	609	581	28		0.954023	12.50000%
D. BROPHY 33-17	07798	517	492	25		0.951644	12.50000%
JP BROPHY 12-17	09962	667	637	30		0.955022	12.50000%
JP BROPHY 44-17	10079	2665	2545	120		0.954972	12.50000%
JP BROPHY 24-17	10417	804	768	36		0.955224	12.50000%
JP BROPHY 14-17	10418	1414	1350	64		0.954738	12.50000%
		8,030	7,662	368		0.953945	
11/01/2007	Section 18						
	API	Produced	Sold	Used	Shrinkage	Percent sold	USA Interest
T. BROPHY 09-18	06204	1251	1238	13		0.989608	18.75000%
T. BROPHY 38-18	06941	582	579	3		0.994845	18.75000%
T. BROPHY 54-18	07231	1014	972	42		0.958580	18.75000%
T. BROPHY 57-18	07239	1679	1610	69		0.958904	18.75000%
J. BROPHY 16-18	07375	679	651	28		0.958763	18.75000%
D. BROPHY 11-18	07426	741	711	30		0.959514	18.75000%
D. BROPHY 24-18	07646	841	806	35		0.958383	18.75000%
JP BROPHY 44-18	09846	1465	1406	59		0.959727	18.75000%
JP BROPHY 42-18	09847	5336	5119	217		0.959333	18.75000%
JP BROPHY 24-18	10031	2963	2843	120		0.959501	18.75000%
JP BROPHY 31-18	10384	2271	2258	13		0.994276	18.75000%
JP BROPHY 33-18	10796	1913	1835	78		0.959226	18.75000%
		20,735	20,028	707		0.967555	
11/01/2007	Section 19						
	API	Produced	Sold	Used	Shrinkage	Percent sold	USA Interest
T. BROPHY 12-19	06244	1134	1076	58		0.948854	
D. BROPHY 02-19	07257	942	894	48		0.949045	
CONRAD 12-19	07437	344	328	16		0.953488	
D. BROPHY 25-19	07616	527	502	25		0.952562	
CONRAD 13-19	07712	515	490	25		0.951456	
D. BROPHY 40-19	07985	42	40	2		0.952381	
M. CONRAD 33-19	09843	1094	1041	53		0.951554	
M. CONRAD 44-19	09844	1644	1565	79		0.951946	
M. CONRAD 24-19	09860	2048	1949	99		0.951660	
JP BROPHY 12-19	09861	893	850	43		0.951848	
JP BROPHY 31-19	09863	2916	2775	141		0.951646	



11/01/2007	Section 19	Continued...						
	API	Produced	Sold	Used	Shrinkage	Percent sold	USA Interest	
JP BROPHY 42-19	09864	1080	1028	52		0.951852		
JP BROPHY 21-19	09965	1075	1023	52		0.951628		
M. CONRAD 13-19	10052	1842	1753	89		0.951683		
		16,096	15,314	782		0.951543		
11/01/2007	Section 20							
	API	Produced	Sold	Used	Shrinkage	Percent sold	USA Interest	
T. BROPHY 13-20	06245	470	446	24		0.948936		
D. BROPHY 07-20	07325	767	732	35		0.954368		
JP BROPHY 42-20	09915	1172	1119	53		0.954778		
JP BROPHY 41-20	09924	2076	1981	95		0.954239		
JP BROPHY 11-20	09925	589	562	27		0.954160		
JP BROPHY 32-20	10411	1088	1038	50		0.954044		
JP BROPHY 33-20	10412	1087	1037	50		0.954002		
JP BROPHY 43-20	10584	876	836	40		0.954338		
		8,125	7,751	374		0.953608		
11/01/2007	Section 21							
	API	Produced	Sold	Used	Shrinkage	Percent sold	USA Interest	
KITZMILLE 13-21	07911	608	596	12		0.980263	31.25000%	
D. BROPHY 41-21	07986	305	299	6		0.980328	31.25000%	
JP BROPHY 12-21	10413	2661	2640	21		0.992108	31.25000%	
KITZMILLE 32-21	10445	670	659	11		0.983582	31.25000%	
BROPHY BR 41-21	10455	432	424	8		0.981481	31.25000%	
BROPHY BR 42-21	10456	401	394	7		0.982544	31.25000%	
JP BROPHY 21-21	10736	2870	2848	22		0.992334	31.25000%	
		7,947	7,860	87		0.984663		
11/01/2007	Section 01							
	API	Produced	Sold	Used	Shrinkage	Percent sold	USA Interest	
D. BROPHY 22-01	07610	1685	1601	84		0.950148		
D. BROPHY 37-01	08043	1187	1128	59		0.950295		
D. BROPHY 43-01	08081	1615	1533	82		0.949226		
JP BROPHY 41-01	09932	1462	1387	75		0.948700		
		5,949	5,649	300		0.949592		
11/01/2007	Section 12							
	API	Produced	Sold	Used	Shrinkage	Percent sold	USA Interest	
T. BROPHY 07-12	06202	702	666	36		0.948718		
T. BROPHY 32-12	06830	722	685	37		0.948753		
D. BROPHY 18-12	07516	865	822	43		0.950289		
D. BROPHY 19-12	07530	122	116	6		0.950820		
D. BROPHY 27-12	07669	740	704	36		0.951351		
D. BROPHY 28-12	07708	356	338	18		0.949438		
D. BROPHY 30-12	07788	465	441	24		0.948387		
D. BROPHY 39-12	07983	404	384	20		0.950495		
JP BROPHY 31-12	09918	574	546	28		0.951220		
JP BROPHY 14-12	09919	1610	1531	79		0.950932		
JP BROPHY 32-12	09920	2075	1973	102		0.950843		
JP BROPHY 12-12	09921	1297	1233	64		0.950655		
JP BROPHY 11-12	09922	1078	1025	53		0.950835		
JP BROPHY 33-12	09974	1371	1303	68		0.950401		
JP BROPHY 34-12	10220	1120	1063	57		0.949107		
		13,501	12,830	671		0.950150		
11/01/2007	Section 13							
	API	Produced	Sold	Used	Shrinkage	Percent sold	USA Interest	
T. BROPHY 08-13	06203	40	38	2		0.950000		
T. BROPHY 56-13	07240	2461	2336	125		0.949208		
J. BROPHY 22-13	07417	1391	1327	64		0.953990		
D. BROPHY 17-13	07505	3357	3212	145		0.956807		
D. BROPHY 23-13	07611	1338	1276	62		0.953662		
D. BROPHY 32-13	07786	729	692	37		0.949246		

11/01/2007	Section 13	Continued...						
	API	Produced	Sold	Used	Shrinkage	Percent sold	USA Interest	
D. BROPHY 31-13	07787	535	508	27		0.949533		
JP BROPHY 11-13	09904	2602	2482	120		0.953882		
JP BROPHY 24-13	09905	1502	1432	70		0.953395		
JP BROPHY 12-13	09906	6001	5723	278		0.953674		
D & S 13-13	09913	1965	1874	91		0.953690		
JP BROPHY 32-13	09937	887	846	41		0.953777		
JP BROPHY 41-13	09938	2771	2643	128		0.953807		
JP BROPHY 34-13	09939	1789	1706	83		0.953605		
JP BROPHY 43-13	09940	2975	2837	138		0.953613		
		30,343	28,932	1411		0.952793		
11/01/2007	Section 24							
	API	Produced	Sold	Used	Shrinkage	Percent sold	USA Interest	
T. BROPHY 39-24	06940	968	921	47		0.951446		
D. BROPHY 08-24	07372	794	758	36		0.954660		
CONRAD 11-24	07373	1078	1029	49		0.954545		
D. BROPHY 09-24	07379	419	400	19		0.954654		
D. BROPHY 21-24	07569	978	934	44		0.955010		
JP BROPHY 31-24	09946	2901	2770	131		0.954843		
JP BROPHY 22-24	09947	2058	1965	93		0.954810		
JP BROPHY 13-24	09948	2856	2727	129		0.954832		
JP BROPHY 11-24	09949	1974	1885	89		0.954914		
JP BROPHY 24-24	09950	2264	2162	102		0.954947		
M. CONRAD 33-24	09966	1749	1670	79		0.954831		
M. CONRAD 44-24	09973	2102	2007	95		0.954805		
JP BROPHY 42-24	10208	2224	2124	100		0.955036		
		22,365	21,352	1013		0.954564		
NUMBER OF WELLS:	103	142,658	136,564	6,094		0.957378		
Gathered by Yuma Gathering								
11/01/2007	Section 06							
	API	Produced	Sold	Used	Shrinkage	Percent sold	USA Interest	
D. BROPHY 29-06	07741	445	435	27	-17	0.977528		
		445	435	27	-17	0.977528		
11/01/2007	Section 19							
	API	Produced	Sold	Used	Shrinkage	Percent sold	USA Interest	
CONRAD 04-19	06944	477	464	31	-18	0.972746		
CONRAD 05-19	06997	800	779	52	-31	0.973750		
		1,277	1,243	83	-49	0.973248		
11/01/2007	Section 20							
	API	Produced	Sold	Used	Shrinkage	Percent sold	USA Interest	
T. BROPHY 41-20	06998	156	152	10	-6	0.974359		
D. BROPHY 42-20	08062	818	797	53	-32	0.974328		
JP BROPHY 23-20	09916	974	949	63	-38	0.974333		
		1,948	1,898	126	-76	0.974340		
11/01/2007	Section 13							
	API	Produced	Sold	Used	Shrinkage	Percent sold	USA Interest	
T. BROPHY 33-13	06821	512	499	33	-20	0.974609		
		512	499	33	-20	0.974609		
11/01/2007	Section 24							
	API	Produced	Sold	Used	Shrinkage	Percent sold	USA Interest	
T. BROPHY 06-24	06185	444	433	29	-18	0.975225		
CONRAD 06-24	07012	671	653	44	-26	0.973174		
T. BROPHY 45-24	07081	175	170	11	-6	0.971429		
		1,290	1,256	84	-50	0.973276		
NUMBER OF WELLS:	10	5,472	5,331	353	-212	0.974148		
NUMBER OF WELLS:	113	148,130	141,895	Total not sold:		6,235		



# VOLUME COMPARISON

28-March-2008

D. BROPHY 30-12

This report shows trends, from less than 1% of gas being used in 2002 to more than 4% used in 2005-2006 and from companies using the volume as reported produced to using the volume reported to COGCC as sold or less.

Company volume printed in blue means company reported the volume produced or more; printed in green, Company reported the volume sold, printed in red, the Company reported less than reported sold.

## VOLUMES FROM REMITTANCE STATEMENTS

MCF AS REPORTED TO COGCC				Mountain Petroleum	ROSEWOOD	J-W/BERRY
Date	Produced	Sold	Percent sold	VOLUME	VOLUME	VOLUME
01/01/2002	898.00	896.00	0.997773	898.00	995.30	984.00
02/01/2002	752.00	751.00	0.998670	752.00	783.84	643.00
03/01/2002	791.00	789.00	0.997472	791.00	777.20	884.00
04/01/2002	779.00	777.00	0.997433	779.00	743.73	891.00
05/01/2002	1244.00	1241.00	0.997588	1243.00	1110.31	1078.00
06/01/2002	1128.00	1126.00	0.998227	1128.00	900.13	984.00
07/01/2002	944.00	942.00	0.997881	944.00	765.16	719.00
08/01/2002	861.00	859.00	0.997677	861.00	704.23	721.00
09/01/2002	782.00	780.00	0.997442	782.00	848.41	713.00
10/01/2002	793.00	791.00	0.997478	793.00	868.44	736.00
11/01/2002	715.00	713.00	0.997203	715.00	737.73	767.00
12/01/2002	721.00	719.00	0.997226	721.00	759.86	
01/01/2003	803.00	801.00	0.997509	803.00	825.72	721.00
02/01/2003	634.00	633.00	0.998423	634.00	603.74	643.00
03/01/2003	751.00	749.00	0.997337	751.00	835.19	721.00
04/01/2003	790.00	788.00	0.997468	790.00	855.32	806.00
05/01/2003	732.00	730.00	0.997268	730.00	746.56	721.00
06/01/2003	667.00	665.00	0.997001	666.00	602.79	698.00
07/01/2003	960.00	958.00	0.997917	958.00	1010.37	930.00
08/01/2003	920.00	918.00	0.997826	917.00	1004.47	930.00
09/01/2003	792.00	790.00	0.997475	917.00	498.24	698.00
	17,457.00	17,416.00	99.763305%	17,573.00	16,976.74	15,988.00

MCF AS REPORTED TO COGCC				Mountain Petroleum	ROSEWOOD	J-W/BERRY
Date	Produced	Sold	Percent sold	VOLUME	VOLUME	VOLUME
10/01/2003	743.00	713.00	0.959623	737.00	468.16	706.00
11/01/2003	754.00	723.00	0.958886	753.00	468.11	745.00
12/01/2003	763.00	732.00	0.959371	755.00	476.58	574.00
01/01/2004	734.00	704.00	0.959128	732.00	472.04	589.00
02/01/2004	612.00	578.00	0.944444	606.00	424.94	442.00
03/01/2004	639.00	607.00	0.949922	639.00	422.68	675.00
04/01/2004	628.00	602.00	0.958599	628.00	362.95	682.00
05/01/2004	628.00	603.00	0.960191	624.00	351.10	698.00
06/01/2004	600.00	576.00	0.960000	600.00	349.59	682.00
07/01/2004	617.00	593.00	0.961102	617.00	396.51	613.00
08/01/2004	598.00	574.00	0.959866	593.00	379.39	706.00
09/01/2004	571.00	548.00	0.959720	570.00	346.17	682.00
10/01/2004	588.00	565.00	0.960884	588.00	359.26	706.00
11/01/2004	567.00	544.00	0.959436	566.00	383.57	458.00
12/01/2004	435.00	418.00	0.960920	569.00	366.11	473.00
01/01/2005	560.00	537.00	0.958929	560.00	334.31	473.00
02/01/2005	506.00	486.00	0.960474	503.00	307.05	427.00
03/01/2005	556.00	534.00	0.960432	555.00	350.82	465.00
04/01/2005	538.00	516.00	0.959108	537.00	345.74	458.00
05/01/2005	577.00	548.00	0.949740	553.00	351.02	
06/01/2005	537.00	510.00	0.949721	515.00	315.53	510.00
07/01/2005	533.00	505.00	0.947467	528.00	311.73	505.00
08/01/2005	531.00	503.00	0.947269	526.00	328.93	503.00
09/01/2005	515.00	488.00	0.947573	509.00	292.72	487.00
10/01/2005	522.00	495.00	0.948276	513.00	313.78	495.00

After October 2003, Continued on next page

MCF AS REPORTED TO COGCC				Mountain Petroleum	ROSEWOOD	J-W/BERRY
Date	Produced	Sold	Percent sold	VOLUME	VOLUME	VOLUME
11/01/2005	493.00	467.00	0.947262	482.00	317.91	467.00
12/01/2005	574.00	546.00	0.951220	525.00	323.58	519.00
01/01/2006	519.00	493.00	0.949904	501.00	282.94	493.00
02/01/2006	463.00	440.00	0.950324	447.00	270.73	440.00
03/01/2006	512.00	486.00	0.949219	495.00	263.78	486.00
04/01/2006	498.00	473.00	0.949799	480.00	272.45	473.00
05/01/2006	513.00	487.00	0.949318	496.00	317.28	487.00
06/01/2006	497.00	472.00	0.949698	481.00	289.57	472.00
07/01/2006	543.00	516.00	0.950276	514.00	325.29	516.00
08/01/2006	502.00	477.00	0.950199	480.00	457.27	477.00
09/01/2006	468.00	444.00	0.948718	450.00	302.74	444.00
10/01/2006	477.00	453.00	0.949686	456.00	279.36	453.00
11/01/2006	438.00	416.00	0.949772	420.00	253.67	416.00
12/01/2006	1102.00	1046.00	0.949183	1056.00	680.31	1046.00
01/01/2007	715.00	679.00	0.949650	688.00	419.84	679.00
02/01/2007	524.00	497.00	0.948473	505.00	315.01	497.00
03/01/2007	581.00	552.00	0.950086	557.00	591.53	552.00
04/01/2007	572.00	542.00	0.947552	559.00	375.26	542.00
05/01/2007	576.00	546.00	0.947917	566.00	357.99	546.00
06/01/2007	501.00	475.00	0.948104	493.00	317.41	475.00
07/01/2007	483.00	458.00	0.948240	480.00	317.04	458.00
08/01/2007	551.00	522.00	0.947368	548.00	332.90	522.00
09/01/2007	457.00	433.00	0.947484	453.00	273.76	433.00
10/01/2007	545.00	517.00	0.948624	536.00	342.98	517.00
11/01/2007	465.00	441.00	0.948387	456.00	286.87	441.00
	28,421.00	27,080.00	95.255088%	28,000.00	17,846.26	26,605.00



An interesting fact about natural gas production in Yuma County Colorado

*Data From COGCC Library*

Production Year	Total Produced	Total Sold	Percent Sold	MCF not sold
December-02	776,939	763,754	98.3030%	13,185
December-03	716,655	700,438	97.7371%	16,217
December-04	659,471	628,641	95.3250%	30,830
December-05	592,123	564,758	95.3785%	27,365
December-06	36,973,411	35,478,084	95.9557%	1,495,327
December-07	36,170,727	34,760,126	96.1002%	1,410,601

*2007 production reports are incomplete. Berry Petroleum Company who operates all the wells in which we own an interest has reported no production for December.*

**Almost twice as much unsold in 2006 as was produced in 2002.**

At only \$3.00 an MCF the used or lost gas in 2006 was worth:

\$4,485,981.00

At 6% ad valorem to the county would be:

\$269,158.86

Colorado Interstate Gas Company index prices for 2006 averaged \$5.22 from January to September and \$4.76 from Oct-Dec.

2007 Index records are incomplete.