

Well Location Sketch:

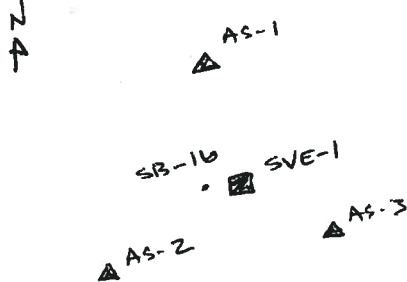

Compliance · Engineering · Remediation

LT Environmental, Inc.

4600 W. 60th Avenue

Arvada, Colorado 80003

BORING LOG/MONITORING WELL COMPLETION DIAGRAM

Boring/Well Number: SVE-1	Project: Noble Bucky				
Date: 11-7-08	Project Number: NEP0826				
Logged By: James F.	Drilled By: Gabe (Dakota)				
Drilling Method: HSA	Sampling Method: Cuttings				
Seal: Butonite Chips	Grout: Portland				
Casing Type: Sch. 40 PVC	Diameter: 2" +	Length: 5	Hole Diameter: 8"	Depth to Liquid: 	
Screen Type: Sch. 40 PVC	Slot: 0.02"	Diameter: 2" +	Length: 18" 3'	Total Depth: 16' 6'	Depth to Water: ?

Penetration Resistance	Moisture Content	Vapor (ppm)	Staining	Sample #	Depth (ft. bgs.)	Sample Run	Recovery	Soil/Rock Type	Lithology/Remarks	Well Completion Diagram
					2				SC sand, fg-mg, clayey, brown.	
					4				- staining & odor	
					6					
					8					
					10					
					12					
					14					
					16					
					18					
					20					
					22					
					24					
					26					
					28					
					30					
					32					
					34					
					36					
					38					

NOTES:

Page of

Well Location Sketch:

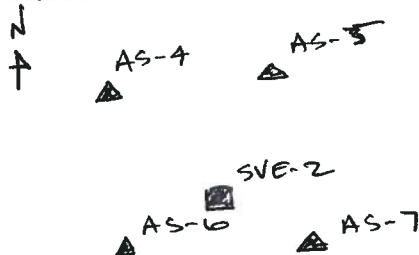

Compliance · Engineering · Remediation

LT Environmental, Inc.

4600 W. 60th Avenue

Arvada, Colorado 80003

BORING LOG/MONITORING WELL COMPLETION DIAGRAM

Boring/Well Number:

SVE-2

Project:

Noble Bucky

Date:

11-7-08

Project Number:

NEP0826

Logged By:

James F.

Drilled By:

Gabe (Dakota)

Drilling Method:

HSA

Sampling Method:

Cuttings

Elevation:

Detector:

MiniPac PID

Gravel Pack:

Colorado Silica #10-20

Seal:

Bedowitz Chips

Grout:

Portland

Casing Type:

Sch. 40 PVC

Diameter:

2" 1/2"

Length:

5'

Hole Diameter:

8"

Depth to Liquid:

Screen Type:

Sch 40 PVC

Slot:

0.02"

Diameter:

2" 1/2"

Length:

18' 3"

Total Depth:

16' 6"

Depth to Water:

7'

Penetration Resistance	Moisture Content	Vapor (ppm)	Staining	Sample #	Depth (ft. bgs.)	Sample Run	Recovery	Soil/Rock Type	Lithology/Remarks	Well Completion Diagram
					2			SC	Sand, fg-mg, clayey, brown, no odor	
					4				staining	
		645	✓		6					
					8					
					10					
					12					
					14					
					16					
					18					
					20					
					22					
					24					
					26					
					28					
					30					
					32					
					34					
					36					
					38					

NOTES:

Page 1 of 1

Well Location Sketch:

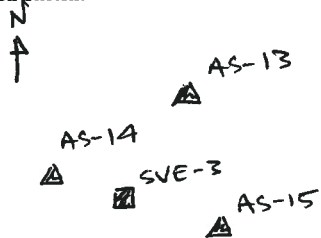

Compliance · Engineering · Remediation

LT Environmental, Inc.

4600 W. 60th Avenue

Arvada, Colorado 80003

BORING LOG/MONITORING WELL COMPLETION DIAGRAM

Boring/Well Number:

SVE-3

Project:

Noble Beckey

Date:

11-7-08

Project Number:

NEP0826

Logged By:

James F.

Drilled By:

Gabe (Dakota)

Drilling Method:

HSA

Sampling Method:

Cuttings

Elevation:

Detector:

MiniRae PID

Gravel Pack:

Colorado Silica #10-20

Seal:

Bentonite Chips

Grout:

Portland

Casing Type:

Sch 40 PVC

Diameter:

1"

Length:

5' 14.5" 16.5'

Hole Diameter:

8"

Depth to Liquid:

Screen Type:

Sch. 40 PVC

Slot:

0.02"

Diameter:

1"

Length:

16' 3'

Total Depth:

16' 6"

Depth to Water:

Penetration Resistance	Moisture Content	Vapor (ppm)	Staining	Sample #	Depth (ft. bgs.)	Sample Run	Recovery	Soil/Rock Type	Lithology/Remarks	Well Completion Diagram
			N		2			SC	S&S, fg-mg, clayey, brown	
		516	Y		4				- stained	
					6					
					8					
					10					
					12					
					14					
					16					
					18					
					20					
					22					
					24					
					26					
					28					
					30					
					32					
					34					
					36					
					38					

NOTES:

Page

of

Well Location Sketch:

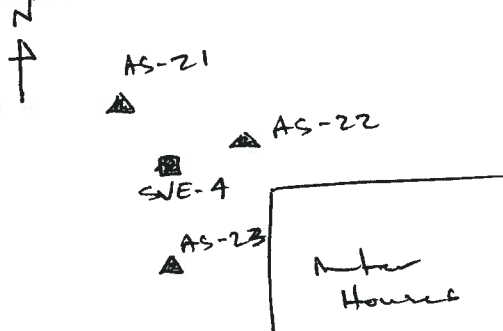

Compliance · Engineering · Remediation

LT Environmental, Inc.

4600 W. 60th Avenue

Arvada, Colorado 80003

BORING LOG/MONITORING WELL COMPLETION DIAGRAM

Boring/Well Number: SVE-4	Project: Noble Bucky
Date: 11-7-08	Project Number: NEP0826
Logged By: James F.	Drilled By: Garza (Dakota)

Elevation: _____	Detector: MiniRae PID	Drilling Method: HSA	Sampling Method: Cuttings
---------------------	---------------------------------	--------------------------------	-------------------------------------

Gravel Pack: Colorado Silica #10-20	Seal: Bentonite Chips	Grout: Portland
---	----------------------------------	---------------------------

Casing Type: Sch 40 PVC	Diameter: 2"	Length: 5	Hole Diameter: 8"	Depth to Liquid: _____
-----------------------------------	------------------------	---------------------	-----------------------------	---------------------------

Screen Type: Sch 40 PVC	Slot: 0.02"	Diameter: 2"	Length: 3	Total Depth: 6	Depth to Water: _____
-----------------------------------	-----------------------	------------------------	---------------------	--------------------------	--------------------------

Penetration Resistance	Moisture Content	Vapor (ppm)	Staining	Sample #	Depth (ft. bgs.)	Sample Run	Recovery	Soil/Rock Type	Lithology/Remarks	Well Completion Diagram
------------------------	------------------	-------------	----------	----------	------------------	------------	----------	----------------	-------------------	-------------------------

									SC	S&S, Ag-mg, clayey, brown stained			
					2								
					4								
		280	Y		6								
					8								
					10								
					12								
					14								
					16								
					18								
					20								
					22								
					24								
					26								
					28								
					30								
					32								
					34								
					36								
					38								

NOTES:

Page of

Well Location Sketch:

▲ AS-10

■ SVE-10

▲ AS-9

▲ AS-11



Compliance · Engineering · Remediation

LT Environmental, Inc.

4600 W. 60th Avenue

Arvada, Colorado 80003

BORING LOG/MONITORING WELL COMPLETION DIAGRAM

Boring/Well Number:

SVE-5

Project:

Noble Boring

Date:

11-7-08

Project Number:

NEP0826

Logged By:

James F.

Drilled By:

Gabe (Dakota)

Drilling Method:

HSA

Sampling Method:

Cuttings

Seal:

Bentonite Chips

Grout:

Portland

Elevation:

Detector:

MiniRae PID

Gravel Pack:

Colorado Silica #10-20

Casing Type:

Sch. 40 PVC

Diameter:

2"

Length:

5'

Hole Diameter:

8"

Depth to Liquid:

Screen Type:

Sch 40 PVC

Slot:

Diameter:

2"

Length:

3'

Total Depth:

6'

Depth to Water:

Penetration Resistance	Moisture Content	Vapor (ppm)	Staining	Sample #	Depth (ft. bgs.)	Sample Run	Recovery	Soil/Rock Type	Lithology/Remarks	Well Completion Diagram
					2			SC	Sand, fg-ng, clayey, brown.	
					4				stained	
		174	Y		6					
					8					
					10					
					12					
					14					
					16					
					18					
					20					
					22					
					24					
					26					
					28					
					30					
					32					
					34					
					36					
					38					

NOTES:

Page

of

Well Location Sketch:



AS-25 SVE-6

 Meter Horizons
 x x x x x

Acacia Road



Compliance · Engineering · Remediation

LT Environmental, Inc.

4600 W. 60th Avenue

Arvada, Colorado 80003

BORING LOG/MONITORING WELL COMPLETION DIAGRAM

Boring/Well Number:

SVE-6

Project:

Noble Bucky

Date:

11-7-08

Project Number:

NEP0826

Logged By:

James F.

Drilled By:

Gabe (Dakota)

Drilling Method:

HSA

Sampling Method:

Cuttings

Seal:

Bedrock Chips

Grout:

Portland

Elevation:

Detector:

MiniRae PID

Gravel Pack:

Colorado Silica #10-20

Casing Type:

Sch. 40 PVC

Diameter:

2"

Length:

5'

Hole Diameter:

8"

Depth to Liquid:

Screen Type:

Sch. 40 PVC

Slot:

Diameter:

2"

Length:

3'

Total Depth:

6'

Depth to Water:

Penetration Resistance	Moisture Content	Vapor (ppm)	Staining	Sample #	Depth (ft. bgs.)	Sample Run	Recovery	Soil/Rock Type	Lithology/Remarks	Well Completion Diagram
					2			SC	Sand, fq-mg, clayey, brown.	
					4					
					6					
					8					
					10					
					12					
					14					
					16					
					18					
					20					
					22					
					24					
					26					
					28					
					30					
					32					
					34					
					36					
					38					

NOTES:

Page

of

Well Location Sketch:

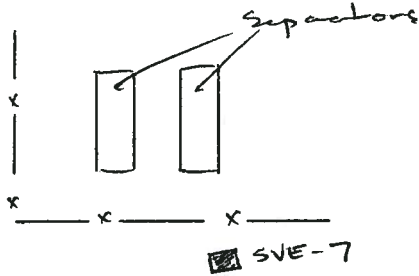

Compliance · Engineering · Remediation

LT Environmental, Inc.

4600 W. 60th Avenue

Arvada, Colorado 80003

BORING LOG/MONITORING WELL COMPLETION DIAGRAM

Boring/Well Number:

SVE-7

Project:

Noble Bucky

Date:

11-7-08

Project Number:

NEP0826

Logged By:

James F.

Drilled By:

Gabe (Dakota)

Drilling Method:

HSA

Sampling Method:

Cuttings

Elevation:

Detector:

MiniPac PID

Gravel Pack:

Colorado Silica #10-20

Seal:

Bentonite Chips

Grout:

Portland

Casing Type:

Sch. 40 PVC

Diameter:

2"

Length:

5'

Hole Diameter:

8"

Depth to Liquid:

Screen Type:

Sch. 40 PVC

Slot:

Diameter:

2"

Length:

3'

Total Depth:

6'

Depth to Water:

Penetration Resistance	Moisture Content	Vapor (ppm)	Staining	Sample #	Depth (ft. bgs.)	Sample Run	Recovery	Soil/Rock Type	Lithology/Remarks	Well Completion Diagram
					2			SC	Sand, fg-mg, clayey, brown. black staining	
					4					
		1107	Y		6					
					8					
					10					
					12					
					14					
					16					
					18					
					20					
					22					
					24					
					26					
					28					
					30					
					32					
					34					
					36					
					38					

NOTES:

Page 1 of 1

Well Location Sketch:

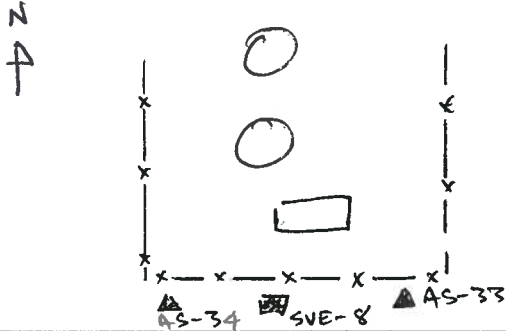

Compliance · Engineering · Remediation

LT Environmental, Inc.

4600 W. 60th Avenue

Arvada, Colorado 80003

BORING LOG/MONITORING WELL COMPLETION DIAGRAM

Boring/Well Number: SVE-8	Project: Noble Beauty
Date: 11-7-08	Project Number: NEPO826
Logged By: James F.	Drilled By: Gabe (Dakota)

Elevation:	Detector: MiniRae PID	Drilling Method: HSA	Sampling Method: Cuttings
------------	--------------------------	-------------------------	------------------------------

Gravel Pack: Colorado Silica #10-20	Seal: Bentonite Chips	Grout: Portland
--	--------------------------	--------------------

Casing Type: Sch 40 PVC	Diameter: 2"	Length: 5'	Hole Diameter: 8"	Depth to Liquid:
----------------------------	-----------------	---------------	----------------------	------------------

Screen Type: Sch. 40 PVC	Slot:	Diameter: 2"	Length: 3'	Total Depth: 6'	Depth to Water:
-----------------------------	-------	-----------------	---------------	--------------------	-----------------

Penetration Resistance	Moisture Content	Vapor (ppm)	Staining	Sample #	Depth (ft. bgs.)	Sample Run	Recovery	Soil/Rock Type	Lithology/Remarks	Well Completion Diagram
------------------------	------------------	-------------	----------	----------	------------------	------------	----------	----------------	-------------------	-------------------------

									SC Sand, fgy. clayey, brown-gray-black staining	
					2					
					4					
					6					
					8					
					10					
					12					
					14					
					16					
					18					
					20					
					22					
					24					
					26					
					28					
					30					
					32					
					34					
					36					
					38					

NOTES:

Page 01

ATTACHMENT 2
LABORATORY ANALYTICAL REPORTS





4640 Pecos Street | Unit C | Denver, Colorado 80211
303.433.1322 Phone 303.265.9645 Fax

November 18, 2008

LT Environmental, Inc.
4600 West 60th Avenue
Arvada CO 80003

Matt Vielhaber
Project Number: NEP0826.01
Project: Becky #2-6

Attached are the analytical results for Becky #2-6 received by Origins Laboratory, Inc. 11/10/2008 4:35:00PM. Please let us know if you have any questions, or if we can help with anything at all.

A handwritten signature in black ink, appearing to read 'Noelle E Doyle', is written in a cursive style.

Laboratory Manager
Noelle E Doyle

The analytical results in the following report were analyzed under the guidelines of EPA Methods specified in SW-846. The analytical results apply specifically to the samples and analyses specified per the attached Chain of Custody. This laboratory report is intended solely for the above addressee and it is only to be used and or reproduced in its entirety.

4640 Pecos Street | Unit C
Denver, Colorado 80211
303.433.1322 | Laboratory
303.265.9645 | Fax



LT Environmental, Inc.
4600 West 60th Avenue
Arvada CO 80003

Matt Vielhaber
Project Number: NEP0826.01
Project: Becky #2-6

CROSS REFERENCE REPORT

Laboratory ID	Sample ID	Matrix	Sampled	Date Received
MW-1	X811042-01	Water	11/10/2008 8:40:00AM	11/10/2008 16:35
MW-3	X811042-02	Water	11/10/2008 8:50:00AM	11/10/2008 16:35
MW-4	X811042-03	Water	11/10/2008 10:00:00AM	11/10/2008 16:35
MW-32	X811042-04	Water	11/10/2008 9:55:00AM	11/10/2008 16:35
MW-34	X811042-05	Water	11/10/2008 9:15:00AM	11/10/2008 16:35
MW-23	X811042-06	Water	11/10/2008 9:25:00AM	11/10/2008 16:35
MW-7	X811042-07	Water	11/10/2008 10:15:00AM	11/10/2008 16:35
MW-8	X811042-08	Water	11/10/2008 12:00:00PM	11/10/2008 16:35
MW-9	X811042-09	Water	11/10/2008 12:20:00PM	11/10/2008 16:35
MW-24	X811042-10	Water	11/10/2008 12:25:00PM	11/10/2008 16:35
MW-11	X811042-11	Water	11/10/2008 11:50:00AM	11/10/2008 16:35
MW-25	X811042-12	Water	11/10/2008 11:00:00AM	11/10/2008 16:35
MW-13	X811042-13	Water	11/10/2008 1:00:00PM	11/10/2008 16:35
MW-14	X811042-14	Water	11/10/2008 1:20:00PM	11/10/2008 16:35
MW-26	X811042-15	Water	11/10/2008 11:10:00AM	11/10/2008 16:35
MW-30	X811042-16	Water	11/10/2008 12:40:00PM	11/10/2008 16:35
MW-27	X811042-17	Water	11/10/2008 11:30:00AM	11/10/2008 16:35

Origins Laboratory, Inc.

Noelle E Doyle, Laboratory Manager

The results in this report apply to the samples analyzed in accordance with the chain of custody document. This analytical report must be reproduced in its entirety.

4640 Pecos Street | Unit C
Denver, Colorado 80211
303.433.1322 | Laboratory
303.265.9645 | Fax



LT Environmental, Inc.
4600 West 60th Avenue
Arvada CO 80003

Matt Vielhaber
Project Number: NEP0826.01
Project: Becky #2-6

CROSS REFERENCE REPORT

Laboratory ID	Sample ID	Matrix	Sampled	Date Received
MW-15	X811042-18	Water	11/10/2008 1:30:00PM	11/10/2008 16:35
MW-18	X811042-19	Water	11/10/2008 2:00:00PM	11/10/2008 16:35
MW-29	X811042-20	Water	11/10/2008 1:35:00PM	11/10/2008 16:35
MW-17	X811042-21	Water	11/10/2008 2:10:00PM	11/10/2008 16:35

Origins Laboratory, Inc.

Noelle E Doyle, Laboratory Manager

The results in this report apply to the samples analyzed in accordance with the chain of custody document. This analytical report must be reproduced in its entirety.

4640 Pecos Street | Unit C
Denver, Colorado 80211
303.433.1322 | Laboratory
303.265.9645 | Fax



LT Environmental, Inc.
4600 West 60th Avenue
Arvada CO 80003

Matt Vielhaber
Project Number: NEP0826.01
Project: Becky #2-6

811042
page 1 of 2



originslaboratory.com
Client: LT Environmental
Address: 4600 W 60th Ave
Arvada CO 80003
Telephone Number: 303 433 9788
E-Mail Address: mvvielhaber@ltenv.com
Project Manager: Matt Vielhaber
Project Name: NOBLE BECKY 2-6
Project Number: NEP0826
Samples Collected by: Julia Vielhaber

Sample ID - Description	Date Sampled	Time Sampled	Number of Containers	Preservative				Matrix			Analysis	Sample Instructions
				Unpreserved	HCl	HNO ₃	Other	Groundwater	Soil	Air - Summa Canister		
MW1	11/10/08	940	3	X	X	X	X	X	X	X	X	
MW2	11/10/08	950	3	X	X	X	X	X	X	X	X	
MW3	11/10/08	1000	3	X	X	X	X	X	X	X	X	
MW2K	11/10/08	955	3	X	X	X	X	X	X	X	X	
MW3K	11/10/08	915	3	X	X	X	X	X	X	X	X	
MW2D	11/10/08	925	3	X	X	X	X	X	X	X	X	
MW7	11/10/08	1005	3	X	X	X	X	X	X	X	X	
MW8	11/10/08	1200	3	X	X	X	X	X	X	X	X	
MW9	11/10/08	1220	3	X	X	X	X	X	X	X	X	
MW12A	11/10/08	1225	3	X	X	X	X	X	X	X	X	
Retrieved by: Julia Vielhaber	Date: 11/10/08	Time: 1035										
Received by: [Signature]	Date: 11-6-08	Time: 1655										
Temperature Upon Receipt: 3.18	Turn Around Time: Same Day	24-hr										
		48-hr										
		Standard										

Origins Laboratory, Inc.

Noelle E Doyle

Noelle E Doyle, Laboratory Manager

The results in this report apply to the samples analyzed in accordance with the chain of custody document. This analytical report must be reproduced in its entirety.

4640 Pecos Street | Unit C
Denver, Colorado 80211
303.433.1322 | Laboratory
303.265.9645 | Fax



LT Environmental, Inc.
4600 West 60th Avenue
Arvada CO 80003

Matt Vielhaber
Project Number: NEP0826.01
Project: Becky #2-6

X8110423
page 2 of 3



originslaboratory.com
Project Manager: Matt Vielhaber
Project Name: Noble Becky 2-6
Project Number: NEP0826.01
Samples Collected by: Julia Rutter MacKinnon

Client: LT Environmental
Address: 4600 W. 60th Ave
Arvada, CO 80003
Telephone Number: 303 433 9788
E-Mail Address: mviehaber@ltenv.com

Sample ID - Description	Date Sampled	Time Sampled	Preservative				Matrix			Analysis		Sample Instructions
			Unpreserved	HCl	HNO ₃	Other	Groundwater	Soil	Air - Summa Canister #	Other	Date	
MW11	11/10/08	11:50										
MW12		11:50										
MW13		12:00										
MW14		12:00										
MW15		12:00										
MW16		12:00										
MW17		12:00										
MW18		12:00										
MW19		12:00										
MW20		12:00										
MW21		12:00										
MW22		12:00										
MW23		12:00										
MW24		12:00										
MW25		12:00										
MW26		12:00										
MW27		12:00										
MW28		12:00										
MW29		12:00										
MW30		12:00										
MW31		12:00										
MW32		12:00										
MW33		12:00										
MW34		12:00										
MW35		12:00										
MW36		12:00										
MW37		12:00										
MW38		12:00										
MW39		12:00										
MW40		12:00										
MW41		12:00										
MW42		12:00										
MW43		12:00										
MW44		12:00										
MW45		12:00										
MW46		12:00										
MW47		12:00										
MW48		12:00										
MW49		12:00										
MW50		12:00										
MW51		12:00										
MW52		12:00										
MW53		12:00										
MW54		12:00										
MW55		12:00										
MW56		12:00										
MW57		12:00										
MW58		12:00										
MW59		12:00										
MW60		12:00										
MW61		12:00										
MW62		12:00										
MW63		12:00										
MW64		12:00										
MW65		12:00										
MW66		12:00										
MW67		12:00										
MW68		12:00										
MW69		12:00										
MW70		12:00										
MW71		12:00										
MW72		12:00										
MW73		12:00										
MW74		12:00										
MW75		12:00										
MW76		12:00										
MW77		12:00										
MW78		12:00										
MW79		12:00										
MW80		12:00										
MW81		12:00										
MW82		12:00										
MW83		12:00										
MW84		12:00										
MW85		12:00										
MW86		12:00										
MW87		12:00										
MW88		12:00										
MW89		12:00										
MW90		12:00										
MW91		12:00										
MW92		12:00										
MW93		12:00										
MW94		12:00										
MW95		12:00										
MW96		12:00										
MW97		12:00										
MW98		12:00										
MW99		12:00										
MW100		12:00										

Relinquished by: Julia Rutter MacKinnon Date: 11/10/08 Time: 16:35
Relinquished by: Date: Time: 16:35

Origins Laboratory, Inc.

Noelle E Doyle

Noelle E Doyle, Laboratory Manager

The results in this report apply to the samples analyzed in accordance with the chain of custody document. This analytical report must be reproduced in its entirety.

Matt Vielhaber
Project Number: NEP0826.01
Project: Becky #2-6

page 3 of 3

originslaboratory.com

Project Manager	<u>Matt Veenker</u>
Project Name	<u>Noble Becky 2-6</u>
Project Number	<u>NEP0826</u>
Samples Collected by	<u>Julia Veenker / Mark Elout</u>

Client:	LT Environmental
Address:	4600 W. 10th Ave Anchorage, AK 99503
Telephone Number:	303 433 9788
E-Mail Address:	anchorage@ltenv.com

[illegible]

40 North Dear Street • Littleton, Colorado 80120 • Laboratory • 303.433.1322 Fax • 303.265.9645

Naale G.

Page 6 of 31

4640 Pecos Street | Unit C
Denver, Colorado 80211
303.433.1322 | Laboratory
303.265.9645 | Fax



LT Environmental, Inc.
4600 West 60th Avenue
Arvada CO 80003

Matt Vielhaber
Project Number: NEP0826.01
Project: Becky #2-6

MW-1

X811042-01 (Water)

Analyte	Result	Reporting		Units	Dilution	Batch	Prepared	Analyzed	Notes
		Limit							

Origins Laboratory, Inc.

BTEX by EPA 8260B

Benzene	ND	0.00100	mg/L	1	8K14002	11/14/2008	11/15/2008
Toluene	ND	0.00100	"	"	"	"	"
Ethylbenzene	ND	0.00100	"	"	"	"	"
o-Xylene	ND	0.00100	"	"	"	"	"
m,p-Xylene	ND	0.00200	"	"	"	"	"

Surrogate: 1,2-Dichloroethane-d4	99.5 %	70.3-123	"	"	"	"
Surrogate: Toluene-d8	104 %	75.9-123	"	"	"	"
Surrogate: 4-Bromofluorobenzene	120 %	83-123	"	"	"	"

Origins Laboratory, Inc.

Noelle E Doyle, Laboratory Manager

The results in this report apply to the samples analyzed in accordance with the chain of custody document. This analytical report must be reproduced in its entirety.

4640 Pecos Street | Unit C
Denver, Colorado 80211
303.433.1322 | Laboratory
303.265.9645 | Fax



LT Environmental, Inc.
4600 West 60th Avenue
Arvada CO 80003

Matt Vielhaber
Project Number: NEP0826.01
Project: Becky #2-6

MW-3

X811042-02 (Water)

Analyte	Result	Reporting		Units	Dilution	Batch	Prepared	Analyzed	Notes
		Limit							

Origins Laboratory, Inc.

BTEX by EPA 8260B

Benzene	0.00126	0.00100	mg/L	1	8K14002	11/14/2008	11/15/2008
Toluene	ND	0.00100	"	"	"	"	"
Ethylbenzene	ND	0.00100	"	"	"	"	"
o-Xylene	ND	0.00100	"	"	"	"	"
m,p-Xylene	ND	0.00200	"	"	"	"	"

Surrogate: 1,2-Dichloroethane-d4	99.6 %	70.3-123	"	"	"	"	"
Surrogate: Toluene-d8	105 %	75.9-123	"	"	"	"	"
Surrogate: 4-Bromofluorobenzene	119 %	83-123	"	"	"	"	"

Origins Laboratory, Inc.

Noelle E Doyle, Laboratory Manager

The results in this report apply to the samples analyzed in accordance with the chain of custody document. This analytical report must be reproduced in its entirety.

4640 Pecos Street | Unit C
Denver, Colorado 80211
303.433.1322 | Laboratory
303.265.9645 | Fax



LT Environmental, Inc.
4600 West 60th Avenue
Arvada CO 80003

Matt Vielhaber
Project Number: NEP0826.01
Project: Becky #2-6

MW-4

X811042-03 (Water)

Analyte	Result	Reporting		Units	Dilution	Batch	Prepared	Analyzed	Notes
		Limit							

Origins Laboratory, Inc.

BTEX by EPA 8260B

Benzene	ND	0.00100	mg/L	1	8K14002	11/14/2008	11/15/2008
Toluene	ND	0.00100	"	"	"	"	"
Ethylbenzene	ND	0.00100	"	"	"	"	"
o-Xylene	ND	0.00100	"	"	"	"	"
m,p-Xylene	ND	0.00200	"	"	"	"	"

Surrogate: 1,2-Dichloroethane-d4	101 %	70.3-123	"	"	"	"	"
Surrogate: Toluene-d8	104 %	75.9-123	"	"	"	"	"
Surrogate: 4-Bromofluorobenzene	120 %	83-123	"	"	"	"	"

Origins Laboratory, Inc.

Noelle E Doyle, Laboratory Manager

The results in this report apply to the samples analyzed in accordance with the chain of custody document. This analytical report must be reproduced in its entirety.

4640 Pecos Street | Unit C
Denver, Colorado 80211
303.433.1322 | Laboratory
303.265.9645 | Fax



LT Environmental, Inc.
4600 West 60th Avenue
Arvada CO 80003

Matt Vielhaber
Project Number: NEP0826.01
Project: Becky #2-6

MW-32

X811042-04 (Water)

Analyte	Result	Reporting		Units	Dilution	Batch	Prepared	Analyzed	Notes
		Limit							

Origins Laboratory, Inc.

BTEX by EPA 8260B

Benzene	ND	0.00100	mg/L	1	8K14002	11/14/2008	11/15/2008
Toluene	ND	0.00100	"	"	"	"	"
Ethylbenzene	ND	0.00100	"	"	"	"	"
o-Xylene	ND	0.00100	"	"	"	"	"
m,p-Xylene	ND	0.00200	"	"	"	"	"

Surrogate: 1,2-Dichloroethane-d4	99.1 %	70.3-123	"	"	"
Surrogate: Toluene-d8	105 %	75.9-123	"	"	"
Surrogate: 4-Bromofluorobenzene	118 %	83-123	"	"	"

Origins Laboratory, Inc.

The results in this report apply to the samples analyzed
in accordance with the chain of custody document. This
analytical report must be reproduced in its entirety.

Noelle E Doyle, Laboratory Manager

4640 Pecos Street | Unit C
Denver, Colorado 80211
303.433.1322 | Laboratory
303.265.9645 | Fax



LT Environmental, Inc.
4600 West 60th Avenue
Arvada CO 80003

Matt Vielhaber
Project Number: NEP0826.01
Project: Becky #2-6

MW-34

X811042-05 (Water)

Analyte	Result	Reporting		Units	Dilution	Batch	Prepared	Analyzed	Notes
		Limit							

Origins Laboratory, Inc.

BTEX by EPA 8260B

Benzene	0.0857	0.00100	mg/L	1	8K14002	11/14/2008	11/15/2008
Toluene	ND	0.00100	"	"	"	"	"
Ethylbenzene	0.0894	0.00100	"	"	"	"	"
o-Xylene	ND	0.00100	"	"	"	"	"
m,p-Xylene	0.108	0.00200	"	"	"	"	"

Surrogate: 1,2-Dichloroethane-d4	94.1 %	70.3-123	"	"	"
Surrogate: Toluene-d8	99.1 %	75.9-123	"	"	"
Surrogate: 4-Bromofluorobenzene	101 %	83-123	"	"	"

Origins Laboratory, Inc.

Noelle E Doyle, Laboratory Manager

The results in this report apply to the samples analyzed in accordance with the chain of custody document. This analytical report must be reproduced in its entirety.

4640 Pecos Street | Unit C
Denver, Colorado 80211
303.433.1322 | Laboratory
303.265.9645 | Fax



LT Environmental, Inc.
4600 West 60th Avenue
Arvada CO 80003

Matt Vielhaber
Project Number: NEP0826.01
Project: Becky #2-6

MW-23

X811042-06 (Water)

Analyte	Reporting		Units	Dilution	Batch	Prepared	Analyzed	Notes
	Result	Limit						

Origins Laboratory, Inc.

BTEX by EPA 8260B

Benzene	0.00146	0.00100	mg/L	1	8K14002	11/14/2008	11/15/2008	
Toluene	ND	0.00100	"	"	"	"	"	
Ethylbenzene	0.00154	0.00100	"	"	"	"	"	
o-Xylene	ND	0.00100	"	"	"	"	"	
m,p-Xylene	ND	0.00200	"	"	"	"	"	

Surrogate: 1,2-Dichloroethane-d4	100 %	70.3-123	"	"	"	"	"	
Surrogate: Toluene-d8	105 %	75.9-123	"	"	"	"	"	
Surrogate: 4-Bromofluorobenzene	111 %	83-123	"	"	"	"	"	

Origins Laboratory, Inc.

Noelle E Doyle, Laboratory Manager

The results in this report apply to the samples analyzed in accordance with the chain of custody document. This analytical report must be reproduced in its entirety.

4640 Pecos Street | Unit C
Denver, Colorado 80211
303.433.1322 | Laboratory
303.265.9645 | Fax



LT Environmental, Inc.
4600 West 60th Avenue
Arvada CO 80003

Matt Vielhaber
Project Number: NEP0826.01
Project: Becky #2-6

MW-7
X811042-07 (Water)

Analyte	Result	Reporting		Units	Dilution	Batch	Prepared	Analyzed	Notes
		Limit							

Origins Laboratory, Inc.

BTEX by EPA 8260B

Benzene	0.725	0.0200	mg/L	20	8K14002	11/14/2008	11/17/2008
Toluene	ND	0.00100	"	1	"	"	11/15/2008
Ethylbenzene	0.493	0.0200	"	20	"	"	11/17/2008
o-Xylene	0.0288	0.00100	"	1	"	"	11/15/2008
m,p-Xylene	5.98	0.0400	"	20	"	"	11/17/2008

Surrogate: 1,2-Dichloroethane-d4	83.9 %	70.3-123	"	"	11/15/2008
Surrogate: Toluene-d8	98.4 %	75.9-123	"	"	"
Surrogate: 4-Bromofluorobenzene	96.3 %	83-123	"	"	"

Origins Laboratory, Inc.

Noelle E Doyle, Laboratory Manager

The results in this report apply to the samples analyzed in accordance with the chain of custody document. This analytical report must be reproduced in its entirety.

4640 Pecos Street | Unit C
Denver, Colorado 80211
303.433.1322 | Laboratory
303.265.9645 | Fax



LT Environmental, Inc.
4600 West 60th Avenue
Arvada CO 80003

Matt Vielhaber
Project Number: NEP0826.01
Project: Becky #2-6

MW-8

X811042-08 (Water)

Analyte	Result	Reporting		Units	Dilution	Batch	Prepared	Analyzed	Notes
		Limit							

Origins Laboratory, Inc.

BTEX by EPA 8260B

Benzene	ND	0.00100	mg/L	1	8K14002	11/14/2008	11/15/2008
Toluene	ND	0.00100	"	"	"	"	"
Ethylbenzene	ND	0.00100	"	"	"	"	"
o-Xylene	ND	0.00100	"	"	"	"	"
m,p-Xylene	ND	0.00200	"	"	"	"	"

Surrogate: 1,2-Dichloroethane-d4	98.8 %	70.3-123	"	"	"
Surrogate: Toluene-d8	103 %	75.9-123	"	"	"
Surrogate: 4-Bromofluorobenzene	110 %	83-123	"	"	"

Origins Laboratory, Inc.

Noelle E Doyle, Laboratory Manager

The results in this report apply to the samples analyzed in accordance with the chain of custody document. This analytical report must be reproduced in its entirety.

4640 Pecos Street | Unit C
Denver, Colorado 80211
303.433.1322 | Laboratory
303.265.9645 | Fax



LT Environmental, Inc.
4600 West 60th Avenue
Arvada CO 80003

Matt Vielhaber
Project Number: NEP0826.01
Project: Becky #2-6

MW-9

X811042-09 (Water)

Analyte	Result	Reporting		Units	Dilution	Batch	Prepared	Analyzed	Notes
		Limit							

Origins Laboratory, Inc.

BTEX by EPA 8260B

Benzene	0.175	0.00100	mg/L	1	8K14002	11/14/2008	11/15/2008
Toluene	ND	0.00100	"	"	"	"	"
Ethylbenzene	0.0247	0.00100	"	"	"	"	"
o-Xylene	ND	0.00100	"	"	"	"	"
m,p-Xylene	0.0779	0.00200	"	"	"	"	"

Surrogate: 1,2-Dichloroethane-d4	92.4 %	70.3-123	"	"	"
Surrogate: Toluene-d8	103 %	75.9-123	"	"	"
Surrogate: 4-Bromofluorobenzene	102 %	83-123	"	"	"

Origins Laboratory, Inc.

Noelle E Doyle, Laboratory Manager

The results in this report apply to the samples analyzed in accordance with the chain of custody document. This analytical report must be reproduced in its entirety.

4640 Pecos Street | Unit C
Denver, Colorado 80211
303.433.1322 | Laboratory
303.265.9645 | Fax



LT Environmental, Inc.
4600 West 60th Avenue
Arvada CO 80003

Matt Vielhaber
Project Number: NEP0826.01
Project: Becky #2-6

MW-24

X811042-10 (Water)

Analyte	Result	Reporting		Units	Dilution	Batch	Prepared	Analyzed	Notes
		Limit							

Origins Laboratory, Inc.

BTEX by EPA 8260B

Benzene	ND	0.00100	mg/L	1	8K14002	11/14/2008	11/15/2008
Toluene	ND	0.00100	"	"	"	"	"
Ethylbenzene	ND	0.00100	"	"	"	"	"
o-Xylene	ND	0.00100	"	"	"	"	"
m,p-Xylene	0.00627	0.00200	"	"	"	"	"

Surrogate: 1,2-Dichloroethane-d4	98.2 %	70.3-123	"	"	"	"	"
Surrogate: Toluene-d8	105 %	75.9-123	"	"	"	"	"
Surrogate: 4-Bromofluorobenzene	115 %	83-123	"	"	"	"	"

Origins Laboratory, Inc.

Noelle E Doyle, Laboratory Manager

The results in this report apply to the samples analyzed in accordance with the chain of custody document. This analytical report must be reproduced in its entirety.

4640 Pecos Street | Unit C
Denver, Colorado 80211
303.433.1322 | Laboratory
303.265.9645 | Fax



LT Environmental, Inc.
4600 West 60th Avenue
Arvada CO 80003

Matt Vielhaber
Project Number: NEP0826.01
Project: Becky #2-6

MW-11

X811042-11 (Water)

Analyte	Result	Reporting		Units	Dilution	Batch	Prepared	Analyzed	Notes
		Limit							

Origins Laboratory, Inc.

BTEX by EPA 8260B

Benzene	ND	0.00100	mg/L	1	8K14002	11/14/2008	11/15/2008
Toluene	ND	0.00100	"	"	"	"	"
Ethylbenzene	ND	0.00100	"	"	"	"	"
o-Xylene	ND	0.00100	"	"	"	"	"
m,p-Xylene	0.00500	0.00200	"	"	"	"	"

Surrogate: 1,2-Dichloroethane-d4	99.5 %	70.3-123	"	"	"
Surrogate: Toluene-d8	104 %	75.9-123	"	"	"
Surrogate: 4-Bromofluorobenzene	107 %	83-123	"	"	"

Origins Laboratory, Inc.

Noelle E Doyle, Laboratory Manager

The results in this report apply to the samples analyzed in accordance with the chain of custody document. This analytical report must be reproduced in its entirety.

4640 Pecos Street | Unit C
Denver, Colorado 80211
303.433.1322 | Laboratory
303.265.9645 | Fax



LT Environmental, Inc.
4600 West 60th Avenue
Arvada CO 80003

Matt Vielhaber
Project Number: NEP0826.01
Project: Becky #2-6

MW-25

X811042-12 (Water)

Analyte	Reporting		Units	Dilution	Batch	Prepared	Analyzed	Notes
	Result	Limit						

Origins Laboratory, Inc.

BTEX by EPA 8260B

Benzene	0.0475	0.00100	mg/L	1	8K14002	11/14/2008	11/15/2008	
Toluene	ND	0.00100	"	"	"	"	"	
Ethylbenzene	0.00773	0.00100	"	"	"	"	"	
o-Xylene	ND	0.00100	"	"	"	"	"	
m,p-Xylene	0.0288	0.00200	"	"	"	"	"	

Surrogate: 1,2-Dichloroethane-d4	97.6 %	70.3-123	"	"	"	"	"	
Surrogate: Toluene-d8	105 %	75.9-123	"	"	"	"	"	
Surrogate: 4-Bromofluorobenzene	106 %	83-123	"	"	"	"	"	

Origins Laboratory, Inc.

Noelle E Doyle, Laboratory Manager

The results in this report apply to the samples analyzed in accordance with the chain of custody document. This analytical report must be reproduced in its entirety.

4640 Pecos Street | Unit C
Denver, Colorado 80211
303.433.1322 | Laboratory
303.265.9645 | Fax



LT Environmental, Inc.
4600 West 60th Avenue
Arvada CO 80003

Matt Vielhaber
Project Number: NEP0826.01
Project: Becky #2-6

MW-13

X811042-13 (Water)

Analyte	Result	Reporting		Units	Dilution	Batch	Prepared	Analyzed	Notes
		Limit							

Origins Laboratory, Inc.

BTEX by EPA 8260B

Benzene	0.684	0.0100	mg/L	10	8K14002	11/14/2008	11/17/2008
Toluene	ND	0.00100	"	1	"	"	11/15/2008
Ethylbenzene	0.0840	0.00100	"	"	"	"	"
o-Xylene	0.00311	0.00100	"	"	"	"	"
m,p-Xylene	0.149	0.00200	"	"	"	"	"

Surrogate: 1,2-Dichloroethane-d4	90.0 %	70.3-123	"	"	"
Surrogate: Toluene-d8	102 %	75.9-123	"	"	"
Surrogate: 4-Bromofluorobenzene	99.6 %	83-123	"	"	"

Origins Laboratory, Inc.

Noelle E Doyle, Laboratory Manager

The results in this report apply to the samples analyzed in accordance with the chain of custody document. This analytical report must be reproduced in its entirety.

4640 Pecos Street | Unit C
Denver, Colorado 80211
303.433.1322 | Laboratory
303.265.9645 | Fax



LT Environmental, Inc.
4600 West 60th Avenue
Arvada CO 80003

Matt Vielhaber
Project Number: NEP0826.01
Project: Becky #2-6

MW-14

X811042-14 (Water)

Analyte	Result	Reporting		Units	Dilution	Batch	Prepared	Analyzed	Notes
		Limit							

Origins Laboratory, Inc.

BTEX by EPA 8260B

Benzene	ND	0.00100	mg/L	1	8K14002	11/14/2008	11/15/2008
Toluene	ND	0.00100	"	"	"	"	"
Ethylbenzene	ND	0.00100	"	"	"	"	"
o-Xylene	ND	0.00100	"	"	"	"	"
m,p-Xylene	ND	0.00200	"	"	"	"	"

Surrogate: 1,2-Dichloroethane-d4	95.8 %	70.3-123	"	"	"	"
Surrogate: Toluene-d8	105 %	75.9-123	"	"	"	"
Surrogate: 4-Bromofluorobenzene	102 %	83-123	"	"	"	"

Origins Laboratory, Inc.

Noelle E Doyle, Laboratory Manager

The results in this report apply to the samples analyzed in accordance with the chain of custody document. This analytical report must be reproduced in its entirety.

4640 Pecos Street | Unit C
Denver, Colorado 80211
303.433.1322 | Laboratory
303.265.9645 | Fax



LT Environmental, Inc.
4600 West 60th Avenue
Arvada CO 80003

Matt Vielhaber
Project Number: NEP0826.01
Project: Becky #2-6

MW-26

X811042-15 (Water)

Analyte	Result	Reporting		Units	Dilution	Batch	Prepared	Analyzed	Notes
		Limit							

Origins Laboratory, Inc.

BTEX by EPA 8260B

Benzene	0.0574	0.00100	mg/L	1	8K14002	11/14/2008	11/15/2008
Toluene	ND	0.00100	"	"	"	"	"
Ethylbenzene	0.0364	0.00100	"	"	"	"	"
o-Xylene	ND	0.00100	"	"	"	"	"
m,p-Xylene	0.0476	0.00200	"	"	"	"	"

Surrogate: 1,2-Dichloroethane-d4	95.2 %	70.3-123	"	"	"
Surrogate: Toluene-d8	102 %	75.9-123	"	"	"
Surrogate: 4-Bromofluorobenzene	99.4 %	83-123	"	"	"

Origins Laboratory, Inc.

Noelle E Doyle, Laboratory Manager

The results in this report apply to the samples analyzed in accordance with the chain of custody document. This analytical report must be reproduced in its entirety.

4640 Pecos Street | Unit C
Denver, Colorado 80211
303.433.1322 | Laboratory
303.265.9645 | Fax



LT Environmental, Inc.
4600 West 60th Avenue
Arvada CO 80003

Matt Vielhaber
Project Number: NEP0826.01
Project: Becky #2-6

MW-30

X811042-16 (Water)

Analyte	Result	Reporting		Units	Dilution	Batch	Prepared	Analyzed	Notes
		Limit							

Origins Laboratory, Inc.

BTEX by EPA 8260B

Benzene	ND	0.00100	mg/L	1	8K14002	11/14/2008	11/15/2008
Toluene	ND	0.00100	"	"	"	"	"
Ethylbenzene	ND	0.00100	"	"	"	"	"
o-Xylene	ND	0.00100	"	"	"	"	"
m,p-Xylene	0.00288	0.00200	"	"	"	"	"

Surrogate: 1,2-Dichloroethane-d4	102 %	70.3-123	"	"	"	"
Surrogate: Toluene-d8	102 %	75.9-123	"	"	"	"
Surrogate: 4-Bromofluorobenzene	110 %	83-123	"	"	"	"

Origins Laboratory, Inc.

Noelle E Doyle, Laboratory Manager

The results in this report apply to the samples analyzed in accordance with the chain of custody document. This analytical report must be reproduced in its entirety.

4640 Pecos Street | Unit C
Denver, Colorado 80211
303.433.1322 | Laboratory
303.265.9645 | Fax



LT Environmental, Inc.
4600 West 60th Avenue
Arvada CO 80003

Matt Vielhaber
Project Number: NEP0826.01
Project: Becky #2-6

MW-27

X811042-17 (Water)

Analyte	Result	Reporting		Units	Dilution	Batch	Prepared	Analyzed	Notes
		Limit							

Origins Laboratory, Inc.

BTEX by EPA 8260B

Benzene	0.00172	0.00100	mg/L	1	8K14002	11/14/2008	11/15/2008
Toluene	ND	0.00100	"	"	"	"	"
Ethylbenzene	ND	0.00100	"	"	"	"	"
o-Xylene	ND	0.00100	"	"	"	"	"
m,p-Xylene	0.0184	0.00200	"	"	"	"	"

Surrogate: 1,2-Dichloroethane-d4	100 %	70.3-123	"	"	"	"	"
Surrogate: Toluene-d8	103 %	75.9-123	"	"	"	"	"
Surrogate: 4-Bromofluorobenzene	116 %	83-123	"	"	"	"	"

Origins Laboratory, Inc.

Noelle E Doyle, Laboratory Manager

The results in this report apply to the samples analyzed in accordance with the chain of custody document. This analytical report must be reproduced in its entirety.

4640 Pecos Street | Unit C
Denver, Colorado 80211
303.433.1322 | Laboratory
303.265.9645 | Fax



LT Environmental, Inc.
4600 West 60th Avenue
Arvada CO 80003

Matt Vielhaber
Project Number: NEP0826.01
Project: Becky #2-6

MW-15
X811042-18 (Water)

Analyte	Result	Reporting		Units	Dilution	Batch	Prepared	Analyzed	Notes
		Limit							

Origins Laboratory, Inc.

BTEX by EPA 8260B

Benzene	ND	0.00100	mg/L	1	8K14002	11/14/2008	11/15/2008
Toluene	ND	0.00100	"	"	"	"	"
Ethylbenzene	ND	0.00100	"	"	"	"	"
o-Xylene	ND	0.00100	"	"	"	"	"
m,p-Xylene	ND	0.00200	"	"	"	"	"

Surrogate: 1,2-Dichloroethane-d4	96.1 %	70.3-123	"	"	"
Surrogate: Toluene-d8	102 %	75.9-123	"	"	"
Surrogate: 4-Bromofluorobenzene	111 %	83-123	"	"	"

Origins Laboratory, Inc.

Noelle E Doyle, Laboratory Manager

The results in this report apply to the samples analyzed in accordance with the chain of custody document. This analytical report must be reproduced in its entirety.

4640 Pecos Street | Unit C
Denver, Colorado 80211
303.433.1322 | Laboratory
303.265.9645 | Fax



LT Environmental, Inc.
4600 West 60th Avenue
Arvada CO 80003

Matt Vielhaber
Project Number: NEP0826.01
Project: Becky #2-6

MW-18

X811042-19 (Water)

Analyte	Result	Reporting		Units	Dilution	Batch	Prepared	Analyzed	Notes
		Limit							

Origins Laboratory, Inc.

BTEX by EPA 8260B

Benzene	ND	0.00100	mg/L	1	8K14002	11/14/2008	11/15/2008
Toluene	ND	0.00100	"	"	"	"	"
Ethylbenzene	ND	0.00100	"	"	"	"	"
o-Xylene	ND	0.00100	"	"	"	"	"
m,p-Xylene	0.00336	0.00200	"	"	"	"	"

Surrogate: 1,2-Dichloroethane-d4	98.8 %	70.3-123	"	"	"
Surrogate: Toluene-d8	108 %	75.9-123	"	"	"
Surrogate: 4-Bromofluorobenzene	105 %	83-123	"	"	"

Origins Laboratory, Inc.

Noelle E Doyle, Laboratory Manager

The results in this report apply to the samples analyzed in accordance with the chain of custody document. This analytical report must be reproduced in its entirety.

4640 Pecos Street | Unit C
Denver, Colorado 80211
303.433.1322 | Laboratory
303.265.9645 | Fax



LT Environmental, Inc.
4600 West 60th Avenue
Arvada CO 80003

Matt Vielhaber
Project Number: NEP0826.01
Project: Becky #2-6

MW-29

X811042-20 (Water)

Analyte	Result	Reporting		Units	Dilution	Batch	Prepared	Analyzed	Notes
		Limit							

Origins Laboratory, Inc.

BTEX by EPA 8260B

Benzene	ND	0.00100	mg/L	1	8K14002	11/14/2008	11/15/2008
Toluene	ND	0.00100	"	"	"	"	"
Ethylbenzene	ND	0.00100	"	"	"	"	"
o-Xylene	ND	0.00100	"	"	"	"	"
m,p-Xylene	ND	0.00200	"	"	"	"	"

Surrogate: 1,2-Dichloroethane-d4	101 %	70.3-123	"	"	"
Surrogate: Toluene-d8	103 %	75.9-123	"	"	"
Surrogate: 4-Bromofluorobenzene	107 %	83-123	"	"	"

Origins Laboratory, Inc.

Noelle E Doyle, Laboratory Manager

The results in this report apply to the samples analyzed in accordance with the chain of custody document. This analytical report must be reproduced in its entirety.

4640 Pecos Street | Unit C
Denver, Colorado 80211
303.433.1322 | Laboratory
303.265.9645 | Fax



LT Environmental, Inc.
4600 West 60th Avenue
Arvada CO 80003

Matt Vielhaber
Project Number: NEP0826.01
Project: Becky #2-6

MW-17

X811042-21 (Water)

Analyte	Result	Reporting	Units	Dilution	Batch	Prepared	Analyzed	Notes
		Limit						

Origins Laboratory, Inc.

BTEX by EPA 8260B

Benzene	ND	0.00100	mg/L	1	8K14002	11/14/2008	11/15/2008	
Toluene	ND	0.00100	"	"	"	"	"	
Ethylbenzene	ND	0.00100	"	"	"	"	"	
o-Xylene	ND	0.00100	"	"	"	"	"	
m,p-Xylene	ND	0.00200	"	"	"	"	"	

Surrogate: 1,2-Dichloroethane-d4	99.8 %	70.3-123	"	"	"	"	"
Surrogate: Toluene-d8	102 %	75.9-123	"	"	"	"	"
Surrogate: 4-Bromofluorobenzene	114 %	83-123	"	"	"	"	"

Origins Laboratory, Inc.

Noelle E Doyle, Laboratory Manager

The results in this report apply to the samples analyzed in accordance with the chain of custody document. This analytical report must be reproduced in its entirety.

4640 Pecos Street | Unit C
Denver, Colorado 80211
303.433.1322 | Laboratory
303.265.9645 | Fax



LT Environmental, Inc.
4600 West 60th Avenue
Arvada CO 80003

Matt Vielhaber
Project Number: NEP0826.01
Project: Becky #2-6

Volatile Organic Compounds by EPA Method 8260B – Quality Control
Origins Laboratory, Inc.

Analyte	Result	Reporting Limit	Units	Spike Level	Source Result	%REC	%REC Limits	RPD	RPD Limit	Notes
Batch 8K14002 – EPA 5030B										
Blank (8K14002-BLK1)				Prepared: 11/14/2008 Analyzed: 11/15/2008						
Benzene	ND	0.001	mg/L							
Toluene	ND	0.001	"							
Ethylbenzene	ND	0.001	"							
o-Xylene	ND	0.001	"							
m,p-Xylene	ND	0.002	"							
Surrogate: 1,2-Dichloroethane-d4	61.4		ug/L	62.5		98.3	70.3-123			
Surrogate: Toluene-d8	66.8		"	62.5		107	75.9-123			
Surrogate: 4-Bromofluorobenzene	74.8		"	62.5		120	83-123			
Blank (8K14002-BLK2)				Prepared: 11/14/2008 Analyzed: 11/15/2008						
Benzene	ND	0.001	mg/L							
Toluene	ND	0.001	"							
Ethylbenzene	ND	0.001	"							
o-Xylene	ND	0.001	"							
m,p-Xylene	ND	0.002	"							
Surrogate: 1,2-Dichloroethane-d4	60.0		ug/L	62.5		95.9	70.3-123			
Surrogate: Toluene-d8	67.3		"	62.5		108	75.9-123			
Surrogate: 4-Bromofluorobenzene	77.0		"	62.5		123	83-123			
LCS (8K14002-BS1)				Prepared: 11/14/2008 Analyzed: 11/15/2008						
Benzene	0.05	0.001	mg/L	0.0500		96.7	64.2-124			
Toluene	0.06	0.001	"	0.0500		113	63.9-119			
Surrogate: 1,2-Dichloroethane-d4	60.4		ug/L	62.5		96.7	70.3-123			
Surrogate: Toluene-d8	66.2		"	62.5		106	75.9-123			
Surrogate: 4-Bromofluorobenzene	72.2		"	62.5		115	83-123			
LCS (8K14002-BS2)				Prepared: 11/14/2008 Analyzed: 11/15/2008						
Benzene	0.05	0.001	mg/L	0.0500		105	64.2-124			
Toluene	0.04	0.001	"	0.0500		86.2	63.9-119			

Origins Laboratory, Inc.

The results in this report apply to the samples analyzed in accordance with the chain of custody document. This analytical report must be reproduced in its entirety.

Noelle E Doyle, Laboratory Manager

4640 Pecos Street | Unit C
 Denver, Colorado 80211
 303.433.1322 | Laboratory
 303.265.9645 | Fax



LT Environmental, Inc.
 4600 West 60th Avenue
 Arvada CO 80003

Matt Vielhaber
 Project Number: NEP0826.01
 Project: Becky #2-6

Volatile Organic Compounds by EPA Method 8260B – Quality Control
Origins Laboratory, Inc.

Analyte	Result	Reporting Limit	Units	Spike Level	Source Result	%REC	%REC Limits	RPD	RPD Limit	Notes
Batch 8K14002 – EPA 5030B										
LCS (8K14002-BS2)					Prepared: 11/14/2008 Analyzed: 11/15/2008					
Surrogate: 1,2-Dichloroethane-d4	61.2		ug/L	62.5		97.9	70.3-123			
Surrogate: Toluene-d8	67.1		"	62.5		107	75.9-123			
Surrogate: 4-Bromofluorobenzene	73.0		"	62.5		117	83-123			
Matrix Spike (8K14002-MS1)					Source: X811038-06		Prepared: 11/14/2008 Analyzed: 11/15/2008			
Benzene	0.05	0.001	mg/L	0.0500	ND	97.8	64.2-124			
Toluene	0.06	0.001	"	0.0500	ND	111	63.9-119			
Surrogate: 1,2-Dichloroethane-d4	61.4		ug/L	62.5		98.2	70.3-123			
Surrogate: Toluene-d8	66.8		"	62.5		107	75.9-123			
Surrogate: 4-Bromofluorobenzene	73.9		"	62.5		118	83-123			
Matrix Spike (8K14002-MS2)					Source: X811038-07		Prepared: 11/14/2008 Analyzed: 11/15/2008			
Benzene	0.05	0.001	mg/L	0.0500	ND	94.6	64.2-124			
Toluene	0.06	0.001	"	0.0500	ND	110	63.9-119			
Surrogate: 1,2-Dichloroethane-d4	60.9		ug/L	62.5		97.5	70.3-123			
Surrogate: Toluene-d8	67.1		"	62.5		107	75.9-123			
Surrogate: 4-Bromofluorobenzene	72.5		"	62.5		116	83-123			
Matrix Spike Dup (8K14002-MSD1)					Source: X811038-06		Prepared: 11/14/2008 Analyzed: 11/15/2008			
Benzene	0.05	0.001	mg/L	0.0500	ND	97.0	64.2-124	0.780	25	
Toluene	0.05	0.001	"	0.0500	ND	110	63.9-119	1.61	25	
Surrogate: 1,2-Dichloroethane-d4	60.7		ug/L	62.5		97.2	70.3-123			
Surrogate: Toluene-d8	66.9		"	62.5		107	75.9-123			
Surrogate: 4-Bromofluorobenzene	72.7		"	62.5		116	83-123			
Matrix Spike Dup (8K14002-MSD2)					Source: X811038-07		Prepared: 11/14/2008 Analyzed: 11/15/2008			
Benzene	0.05	0.001	mg/L	0.0500	ND	95.4	64.2-124	0.842	25	
Toluene	0.05	0.001	"	0.0500	ND	107	63.9-119	2.88	25	
Surrogate: 1,2-Dichloroethane-d4	60.9		ug/L	62.5		97.4	70.3-123			

Origins Laboratory, Inc.

Noelle E Doyle, Laboratory Manager

The results in this report apply to the samples analyzed in accordance with the chain of custody document. This analytical report must be reproduced in its entirety.

4640 Pecos Street | Unit C
Denver, Colorado 80211
303.433.1322 | Laboratory
303.265.9645 | Fax



LT Environmental, Inc.
4600 West 60th Avenue
Arvada CO 80003

Matt Vielhaber
Project Number: NEP0826.01
Project: Becky #2-6

Volatile Organic Compounds by EPA Method 8260B – Quality Control
Origins Laboratory, Inc.

Analyte	Result	Reporting Limit	Units	Spike Level	Source Result	%REC	%REC Limits	RPD	RPD Limit	Notes
---------	--------	-----------------	-------	-------------	---------------	------	-------------	-----	-----------	-------

Batch 8K14002 – EPA 5030B

Matrix Spike Dup (8K14002-MSD2)

Source: X811038-07

Prepared: 11/14/2008 Analyzed: 11/15/2008

Surrogate: Toluene-d8	66.4	ug/L	62.5	106	75.9-123
Surrogate: 4-Bromofluorobenzene	72.3	"	62.5	116	83-123

Origins Laboratory, Inc.

Noelle E Doyle, Laboratory Manager

The results in this report apply to the samples analyzed in accordance with the chain of custody document. This analytical report must be reproduced in its entirety.

4640 Pecos Street | Unit C
Denver, Colorado 80211
303.433.1322 | Laboratory
303.265.9645 | Fax



LT Environmental, Inc.

4600 West 60th Avenue

Arvada CO 80003

Matt Vielhaber

Project Number: NEP0826.01

Project: Becky #2-6

Notes and Definitions

ND Analyte NOT DETECTED at or above the reporting limit

RPD Relative Percent Difference

Origins Laboratory, Inc.

Noelle E Doyle, Laboratory Manager

The results in this report apply to the samples analyzed in accordance with the chain of custody document. This analytical report must be reproduced in its entirety.



4640 Pecos Street | Unit C | Denver, Colorado 80211
303.433.1322 Phone 303.265.9645 Fax

November 18, 2008

LT Environmental, Inc.
4600 West 60th Avenue
Arvada CO 80003

Matt Vielhaber
Project Number: NEP0826.01
Project: Becky #2-6

Attached are the analytical results for Becky #2-6 received by Origins Laboratory, Inc. 11/14/2008 2:28:00PM. Please let us know if you have any questions, or if we can help with anything at all.

Laboratory Manager

Noelle E Doyle

The analytical results in the following report were analyzed under the guidelines of EPA Methods specified in SW-846. The analytical results apply specifically to the samples and analyses specified per the attached Chain of Custody. This laboratory report is intended solely for the above addressee and it is only to be used and or reproduced in its entirety.

4640 Pecos Street | Unit C
Denver, Colorado 80211
303.433.1322 | Laboratory
303.265.9645 | Fax



LT Environmental, Inc.
4600 West 60th Avenue
Arvada CO 80003

Matt Vielhaber
Project Number: NEP0826.01
Project: Becky #2-6

CROSS REFERENCE REPORT

Laboratory ID	Sample ID	Matrix	Sampled	Date Received
MW16	X811060-01	Water	11/13/2008 9:00:00AM	11/14/2008 14:28

Origins Laboratory, Inc.

Noelle E Doyle, Laboratory Manager

The results in this report apply to the samples analyzed in accordance with the chain of custody document. This analytical report must be reproduced in its entirety.

4640 Pecos Street | Unit C
Denver, Colorado 80211
303.433.1322 | Laboratory
303.265.9645 | Fax



LT Environmental, Inc.
4600 West 60th Avenue
Arvada CO 80003

Matt Vielhaber
Project Number: NEP0826.01
Project: Becky #2-6

X811060
page 1 of 1



originslaboratory.com

Client: LT Environmental Inc.
Address: 4600 West 60th Ave
Arvada CO
Telephone Number: 303-433-9288
E-Mail Address: LTENV.COM

Project Manager: Matt Vielhaber
Project Name: Becky #2
Project Number: NEP0826
Samples Collected by: Arvada

Sample ID - Description	Date Sampled	Time Sampled	Number of Containers		Preservative		Matrix		Analysis	Sample Instructions
			Unpreserved	Preserved	Unpreserved	Preserved	Other	Other		
1	11-14-08	0900	3	3	NOI		Soil			
2										
3										
4										
5										
6										
7										
8										
9										
10										

Relinquished by: [Signature] Date: 11-14-08 Time: 1428

Relinquished by: [Signature] Date: 11-14-08 Time: 1428

Turn Around Time: 24 hr

Standard: 72 hr

4640 North Pecos Street Unit C Denver, Colorado 80211 Laboratory - 303.433.1322 Fax - 303.265.9645

Origins Laboratory, Inc.

Noelle E Doyle

Noelle E Doyle, Laboratory Manager

The results in this report apply to the samples analyzed in accordance with the chain of custody document. This analytical report must be reproduced in its entirety.

4640 Pecos Street | Unit C
Denver, Colorado 80211
303.433.1322 | Laboratory
303.265.9645 | Fax



LT Environmental, Inc.
4600 West 60th Avenue
Arvada CO 80003

Matt Vielhaber
Project Number: NEP0826.01
Project: Becky #2-6

MW16
X811060-01 (Water)

Analyte	Result	Reporting		Units	Dilution	Batch	Prepared	Analyzed	Notes
		Limit							

Origins Laboratory, Inc.

BTEX by EPA 8260B

Benzene	ND	0.00100	mg/L	1	8K15002	11/15/2008	11/17/2008
Toluene	ND	0.00100	"	"	"	"	"
Ethylbenzene	ND	0.00100	"	"	"	"	"
o-Xylene	0.00686	0.00100	"	"	"	"	"
m,p-Xylene	0.214	0.00200	"	"	"	"	"

Surrogate: 1,2-Dichloroethane-d4	106 %	70.3-123	"	"	11/17/2008
Surrogate: Toluene-d8	101 %	75.9-123	"	"	"
Surrogate: 4-Bromofluorobenzene	104 %	83-123	"	"	"

Origins Laboratory, Inc.

Noelle E Doyle, Laboratory Manager

The results in this report apply to the samples analyzed in accordance with the chain of custody document. This analytical report must be reproduced in its entirety.

4640 Pecos Street | Unit C
Denver, Colorado 80211
303.433.1322 | Laboratory
303.265.9645 | Fax



LT Environmental, Inc.
4600 West 60th Avenue
Arvada CO 80003

Matt Vielhaber
Project Number: NEP0826.01
Project: Becky #2-6

Volatile Organic Compounds by EPA Method 8260B – Quality Control
Origins Laboratory, Inc.

Analyte	Result	Reporting Limit	Units	Spike Level	Source Result	%REC	%REC Limits	RPD	RPD Limit	Notes
---------	--------	-----------------	-------	-------------	---------------	------	-------------	-----	-----------	-------

Batch 8K15002 – EPA 5030B

Blank (8K15002-BLK1)

Prepared: 11/15/2008 Analyzed: 11/18/2008

Benzene	ND	0.001	mg/L							
Toluene	ND	0.001	"							
Ethylbenzene	ND	0.001	"							
o-Xylene	ND	0.001	"							
m,p-Xylene	ND	0.002	"							
Surrogate: 1,2-Dichloroethane-d4	63.8		ug/L	62.5		102	70.3-123			
Surrogate: Toluene-d8	62.5		"	62.5		100	75.9-123			
Surrogate: 4-Bromofluorobenzene	65.5		"	62.5		105	83-123			

LCS (8K15002-BS1)

Prepared: 11/15/2008 Analyzed: 11/16/2008

Benzene	0.06	0.001	mg/L	0.0500		115	64.2-124			
Toluene	0.06	0.001	"	0.0500		119	63.9-119			
Surrogate: 1,2-Dichloroethane-d4	65.6		ug/L	62.5		105	70.3-123			
Surrogate: Toluene-d8	63.6		"	62.5		102	75.9-123			
Surrogate: 4-Bromofluorobenzene	63.1		"	62.5		101	83-123			

Matrix Spike (8K15002-MS1)

Source: X811059-01

Prepared: 11/15/2008 Analyzed: 11/16/2008

Benzene	0.06	0.001	mg/L	0.0500	0.006	106	64.2-124			
Toluene	0.05	0.001	"	0.0500	0.0007	108	63.9-119			
Surrogate: 1,2-Dichloroethane-d4	65.0		ug/L	62.5		104	70.3-123			
Surrogate: Toluene-d8	63.3		"	62.5		101	75.9-123			
Surrogate: 4-Bromofluorobenzene	63.9		"	62.5		102	83-123			

Matrix Spike Dup (8K15002-MSD1)

Source: X811059-01

Prepared: 11/15/2008 Analyzed: 11/16/2008

Benzene	0.06	0.001	mg/L	0.0500	0.006	98.2	64.2-124	6.51	25	
Toluene	0.05	0.001	"	0.0500	0.0007	102	63.9-119	5.98	25	
Surrogate: 1,2-Dichloroethane-d4	64.5		ug/L	62.5		103	70.3-123			
Surrogate: Toluene-d8	63.7		"	62.5		102	75.9-123			
Surrogate: 4-Bromofluorobenzene	63.0		"	62.5		101	83-123			

Origins Laboratory, Inc.

Noelle E Doyle, Laboratory Manager

The results in this report apply to the samples analyzed in accordance with the chain of custody document. This analytical report must be reproduced in its entirety.

4640 Pecos Street | Unit C
Denver, Colorado 80211
303.433.1322 | Laboratory
303.265.9645 | Fax



LT Environmental, Inc.
4600 West 60th Avenue
Arvada CO 80003

Matt Vielhaber
Project Number: NEP0826.01
Project: Becky #2-6

Notes and Definitions

ND Analyte NOT DETECTED at or above the reporting limit
RPD Relative Percent Difference

Origins Laboratory, Inc.

Noelle E Doyle, Laboratory Manager

The results in this report apply to the samples analyzed in accordance with the chain of custody document. This analytical report must be reproduced in its entirety.