

Remed # 1768 2/1/2005

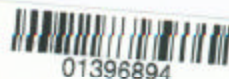

Dec. 2004 Groundwater Sampling Results

APPENDIX A

FIGURES

- Probe/monitoring wells installed Feb 2004
- 24-inch monitoring wells installed August 2003
- 24-inch remediation pump and monitoring wells

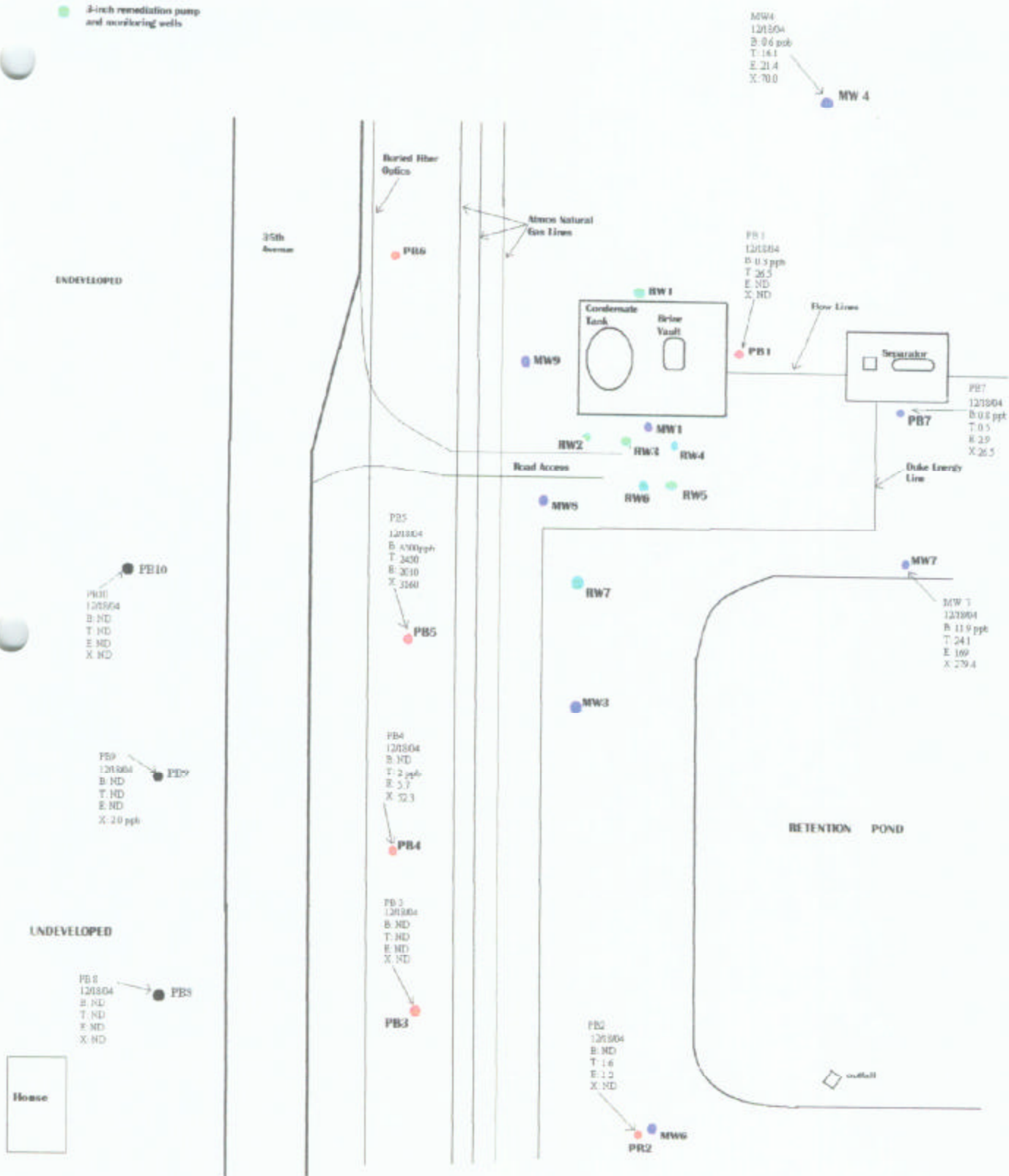

GROUNDWATER LABORATORY RESULTS ANDERSON COMBS 6 DECEMBER 2004

Well locations are surveyed
Buried line locations are estimated per the 3-5
curriculum of utility location markings.

- Probe/monitoring wells installed Feb 2004
- 2-inch monitoring wells installed August 2003
- 3-inch remediation pump and monitoring wells

(100.0) Water depth elevation corrected to 100' datum

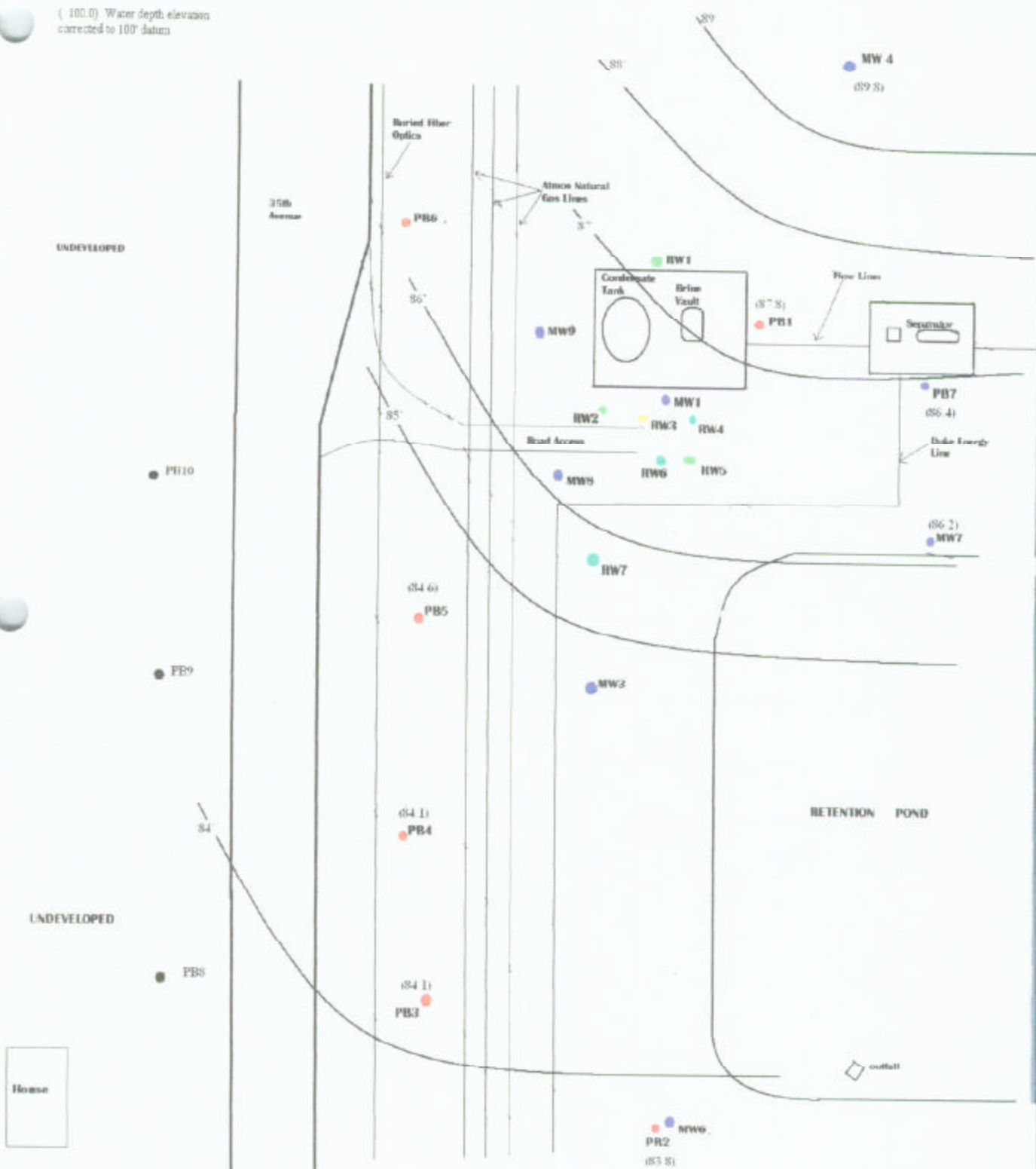

Well locations are surveyed
Buried line locations are estimated per the 3-5' variations of utility locator markings.

GROUNDWATER DEPTH / FLOW MAP
ANDERSON COMBS 6, TANK BATTERY
DECEMBER 2004