

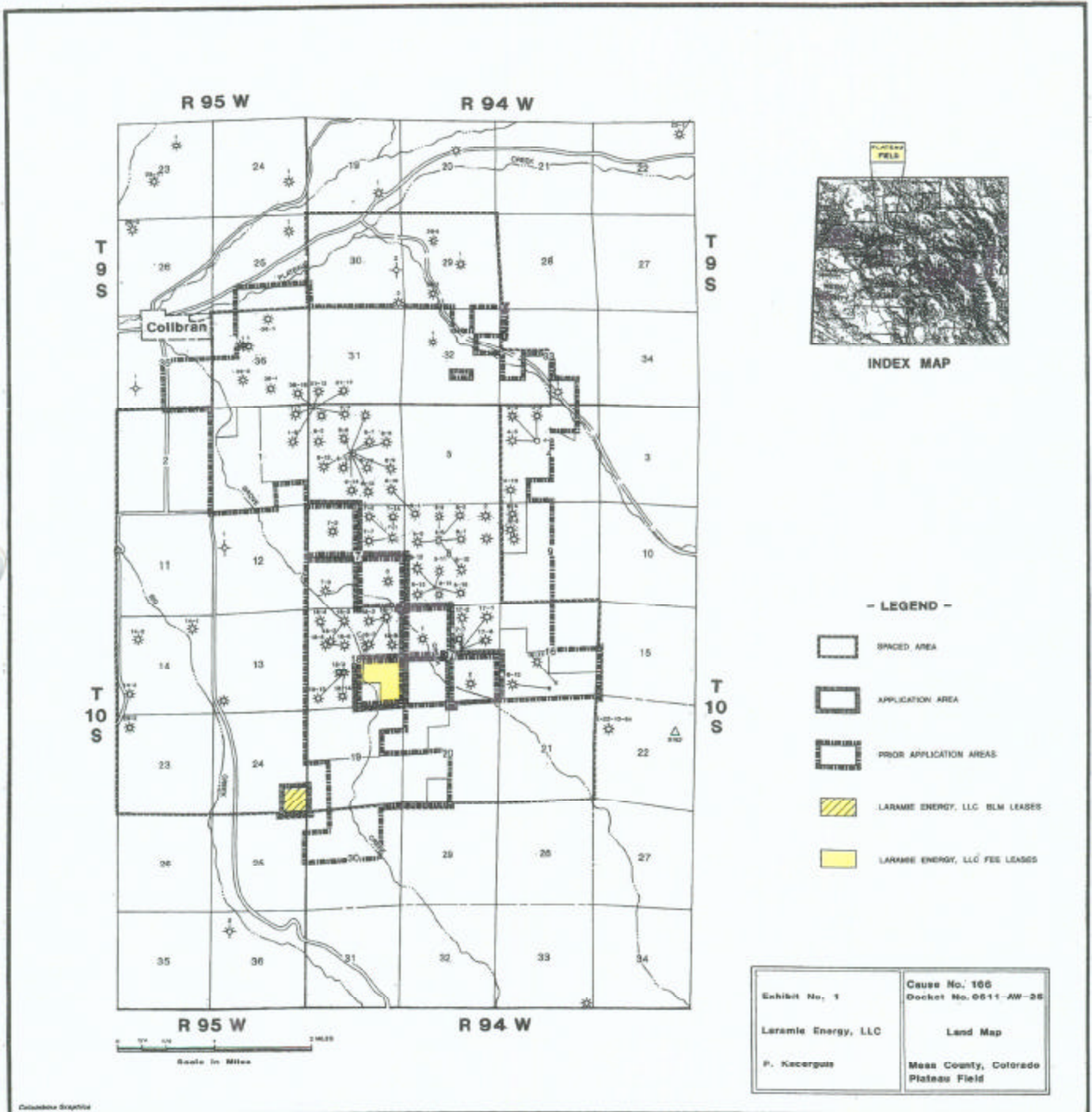

01381781

166-24





INDEX MAP

- LEGEND -

- SPACED AREA
- APPLICATION AREA
- PRIOR APPLICATION AREAS
- LARAMIE ENERGY, LLC LEASEHOLD
- NOT DEEP ENOUGH

Exhibit No. 2

Laramie Energy, LLC

T. D. Kirkpatrick

Cause No. 166
Docket No. 0611-AW-25

Structure Top Rollins Fm.
CL = 100 Feet

Mesa County, Colorado
Plateau Field

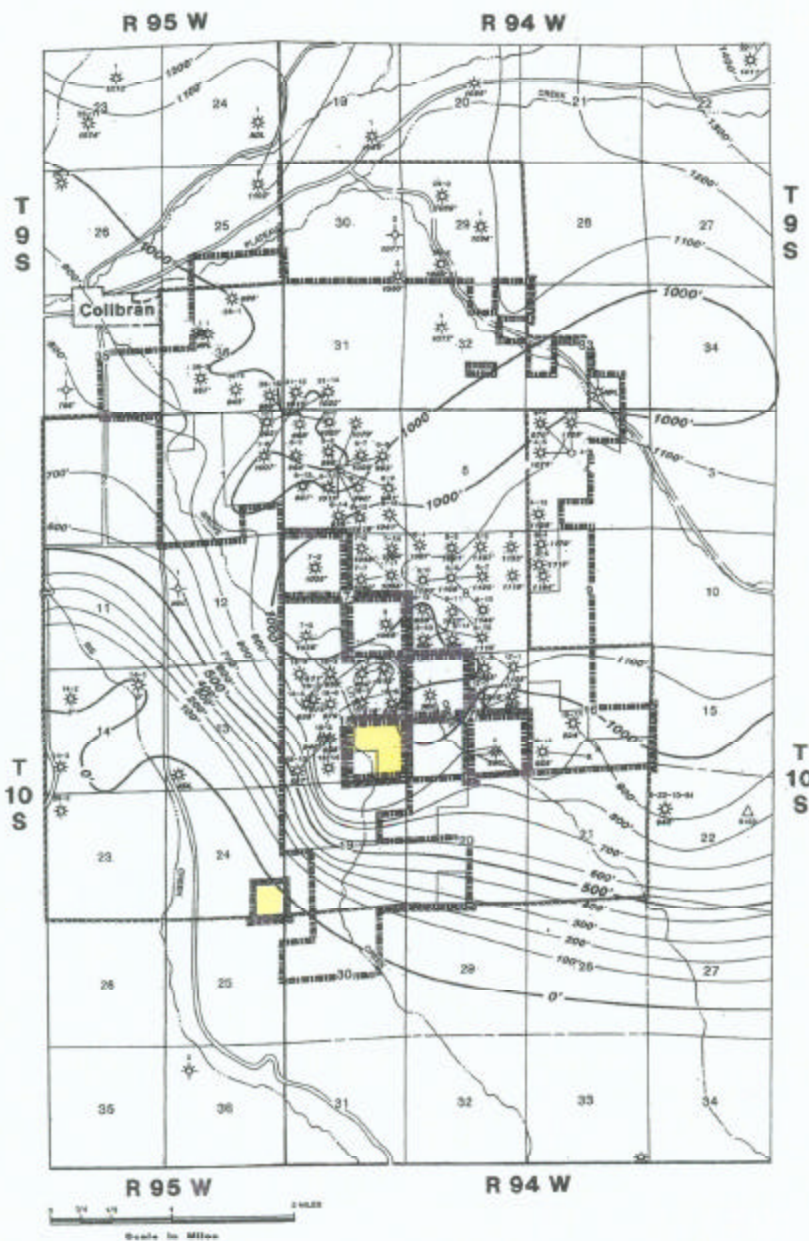

INDEX MAP

- LEGEND -

- SPACED AREA
- APPLICATION AREA
- PRIOR APPLICATION AREAS
- LARAMIE ENERGY, LLC LEASEHOLD
- ND NOT DEEP ENOUGH
- NPL NO POROSITY LOG
- NH NO DENSITY LOG

Exhibit No. 3

Laramie Energy, LLC

T. D. Kirkpatrick

Cause No. 166
Docket No. 0611-AW-26
Williams Fork Fm.
Basin Centered
Gas System
leapach:
Gas Saturated Interval
CLL < 100 Feet
Mesa County, Colorado
Plateau Field

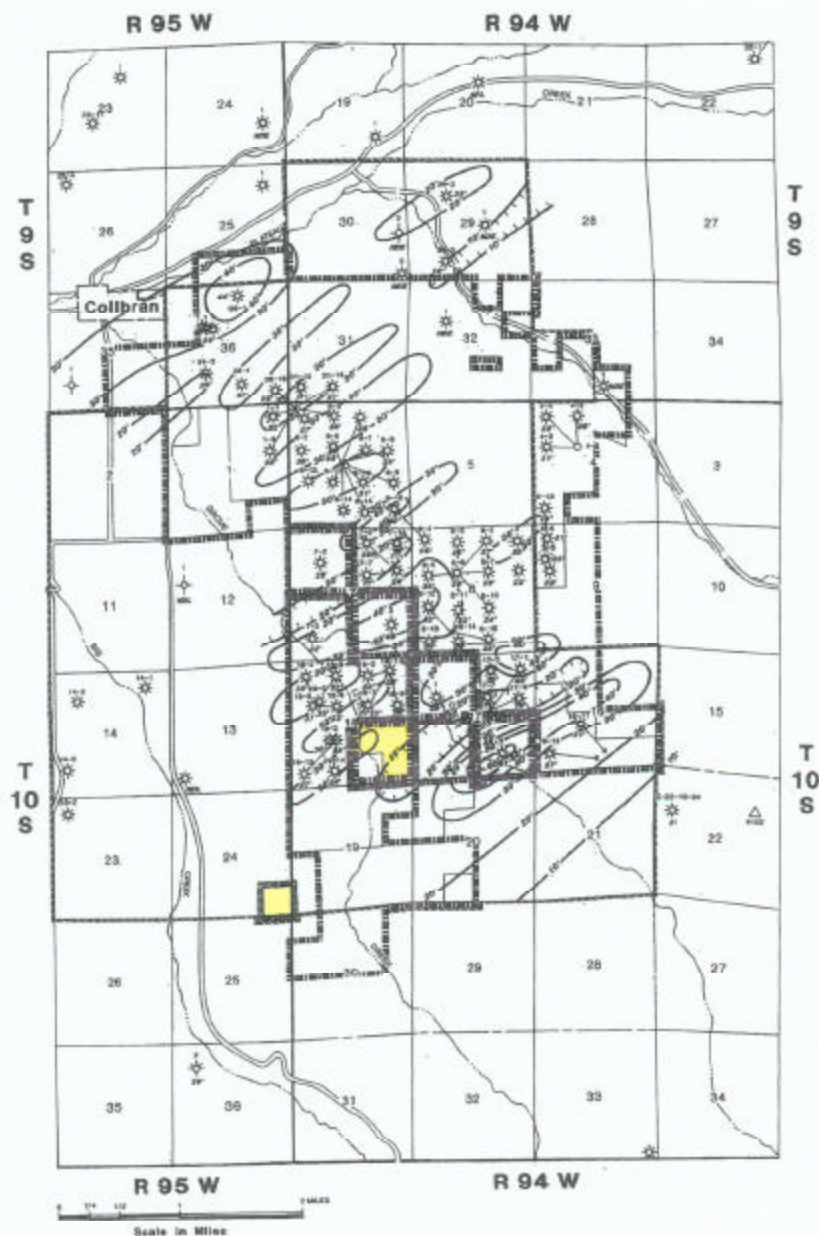

INDEX MAP

- LEGEND -

- SHADED AREA
- APPLICATION AREA
- PRIOR APPLICATION AREAS
- LARAMIE ENERGY, LLC LEASEHOLD
- NW NOT DEEP ENOUGH
- PM NO POROSITY LOG
- MX NO DENSITY LOG

Exhibit No. 4
Laramie Energy, LLC
T. D. Kirkpatrick

Caspe No. 166
Docket No. 0611-AW-26
Lower Cozzette
Net Sand Isopach
(Net 275 API/6% Density Porosity)
G.I. = 10 Feet
Mesa County, Colorado
Plateau Field

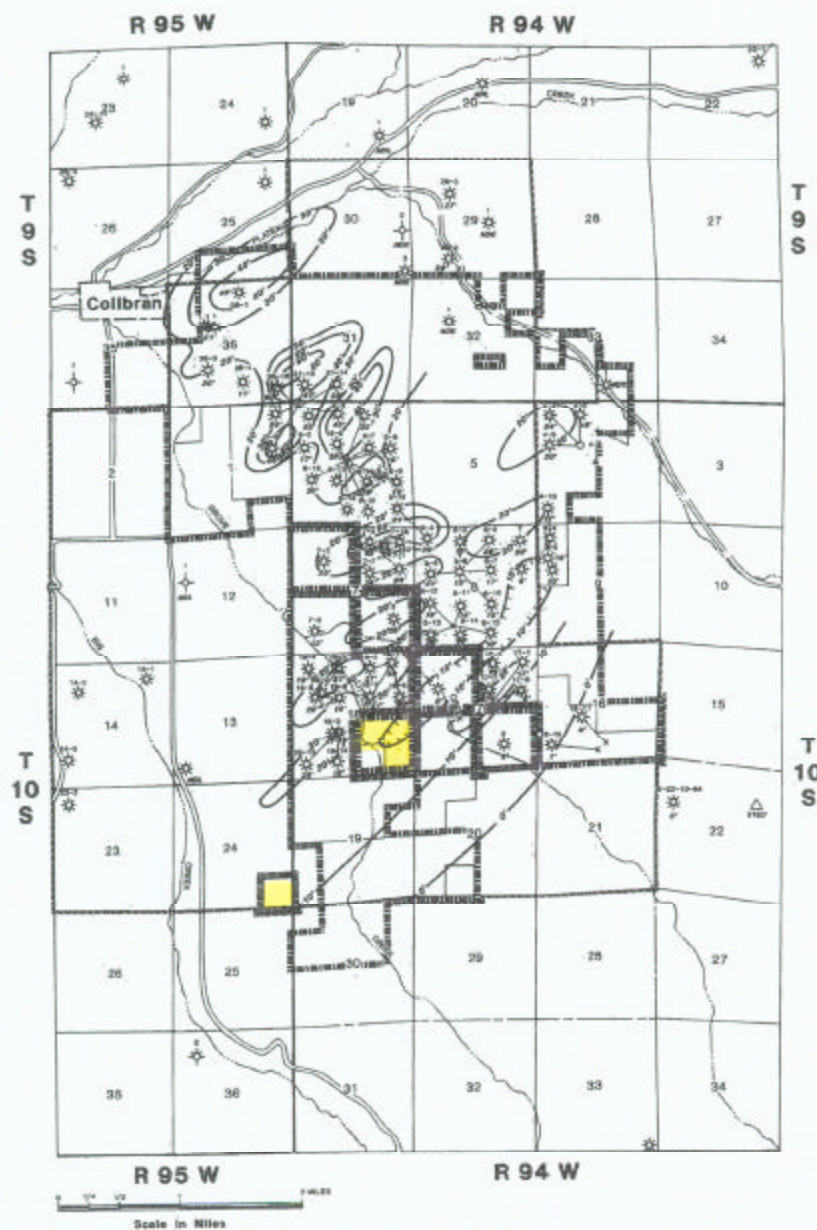

INDEX MAP

- LEGEND -

- SPACED AREA
- APPLICATION AREA
- PRIOR APPLICATION AREAS
- LARAMIE ENERGY, LLC LEASEHOLD
- NOT DEEP ENOUGH
- NO POROSITY LOG
- NO DENSITY LOG

Exhibit No. 5
Laramie Energy, LLC
T. D. Kirkpatrick

Case No. 166
Docket No. 0611-AW-25
Upper Corcoran
Nat Sand Isopach
(Dist: 2% API/6% Density Porosity)
C.I. = 10 Feet
Mesa County, Colorado
Plateau Field

