

429-4

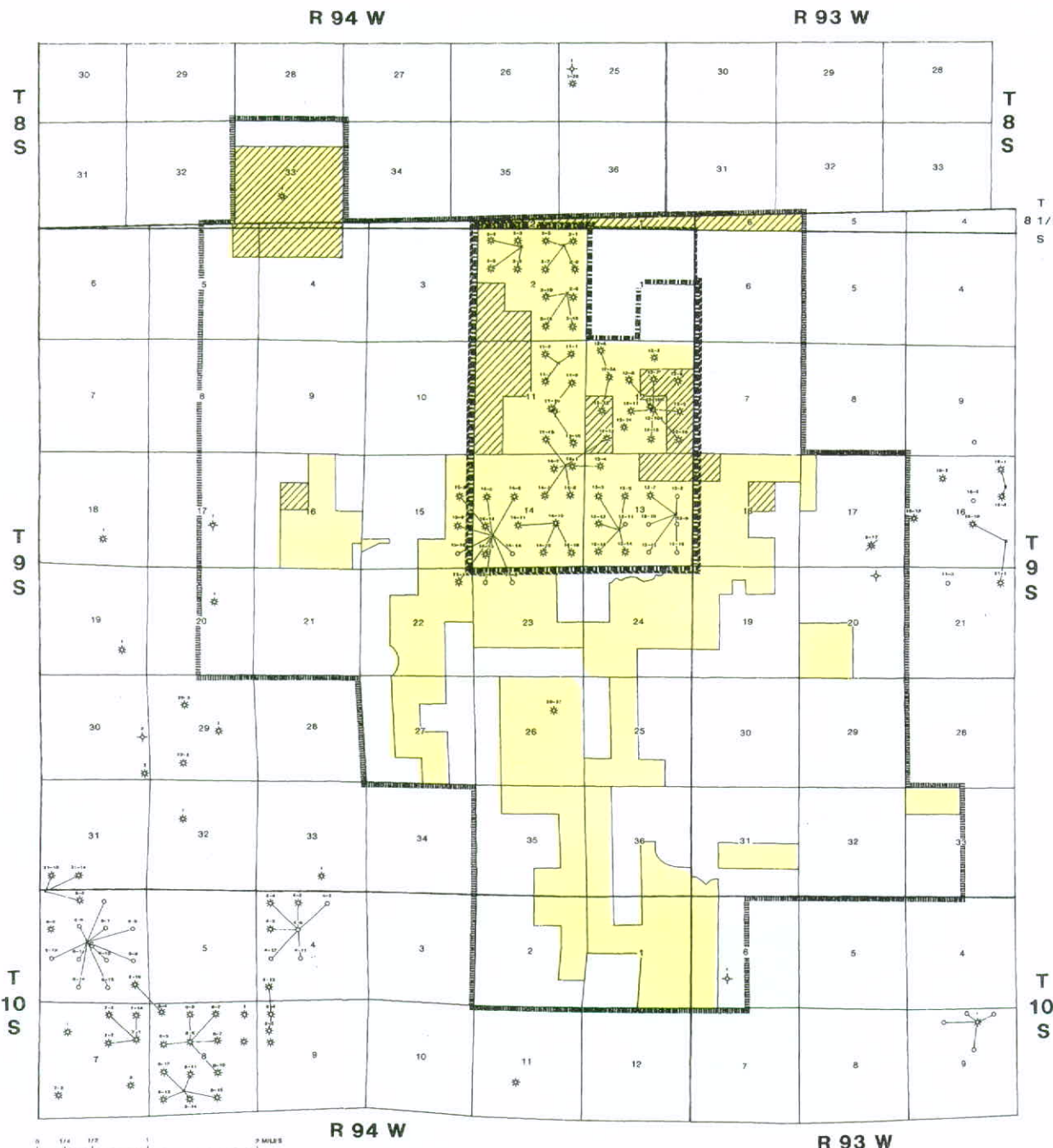

01754654



INDEX MAP

- LEGEND -

- SPACED AREA
- APPLICATION AREA
- PRIOR APPLICATION AREAS
- LARAMIE ENERGY, LLC BLM LEASES
- LARAMIE ENERGY, LLC FEE LEASES

Exhibit No. 1	Cause No. 429 Docket No. 0606-AW-08
Laramie Energy, LLC	Land Map
P. Kacerguis	Mesa County, Colorado Brush Creek Field

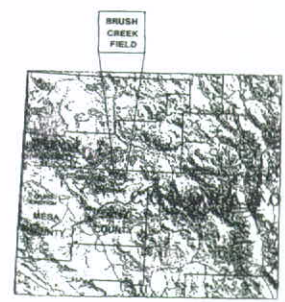
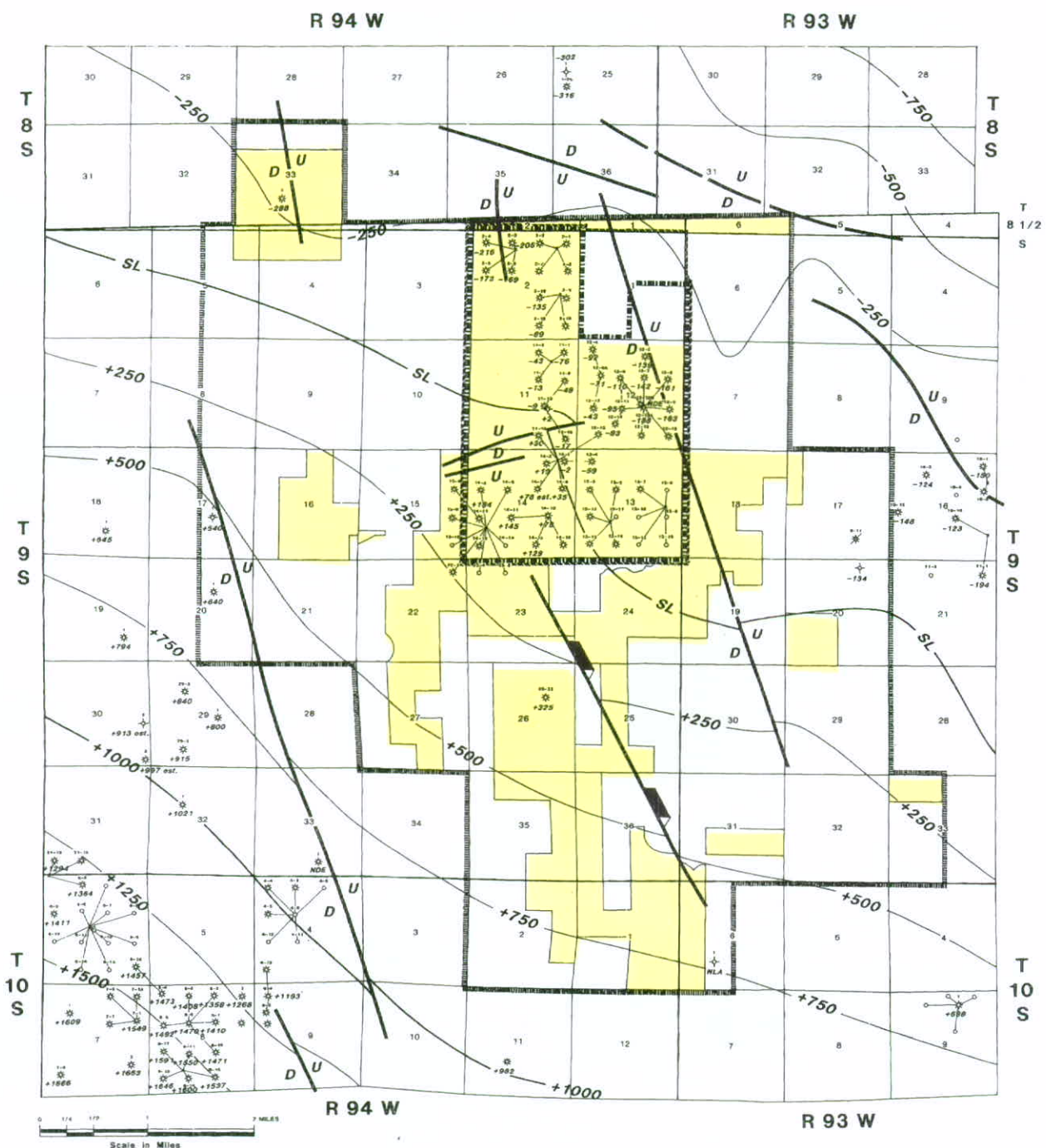

INDEX MAP

- LEGEND -

- SPACED AREA
- APPLICATION AREA
- PRIOR APPLICATION AREAS
- LARAMIE ENERGY, LLC LEASEHOLD

Exhibit No. 2	Cause No. 429 Docket No. 0606-AW-08
Laramie Energy, LLC	Structure Top Rollins Fm. C.I. = 380 Feet
T. D. Kirkpatrick	Mesa County, Colorado Brush Creek Field



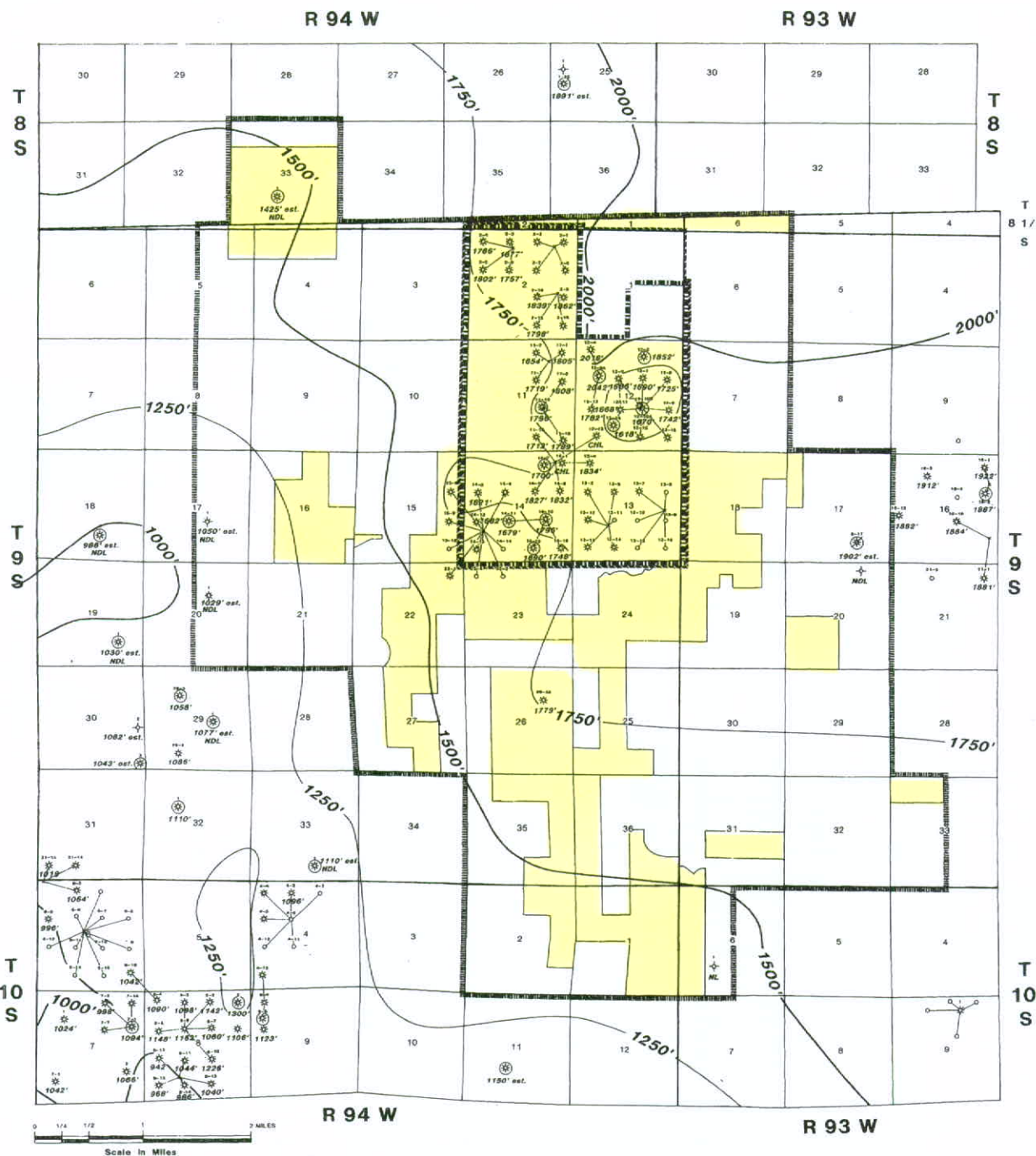

INDEX MAP

- LEGEND -

- SPACED AREA
- APPLICATION AREA
- PRIOR APPLICATION AREAS
- LARAMIE ENERGY, LLC LEASEHOLD
- COMPLETED IN WILLIAMS FORK
- NOT DEEP ENOUGH
- NO DENSITY LOG

Exhibit No. 3

Laramie Energy, LLC



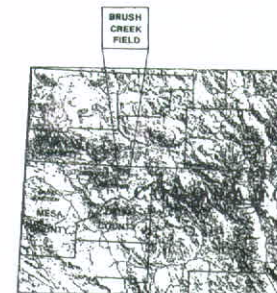
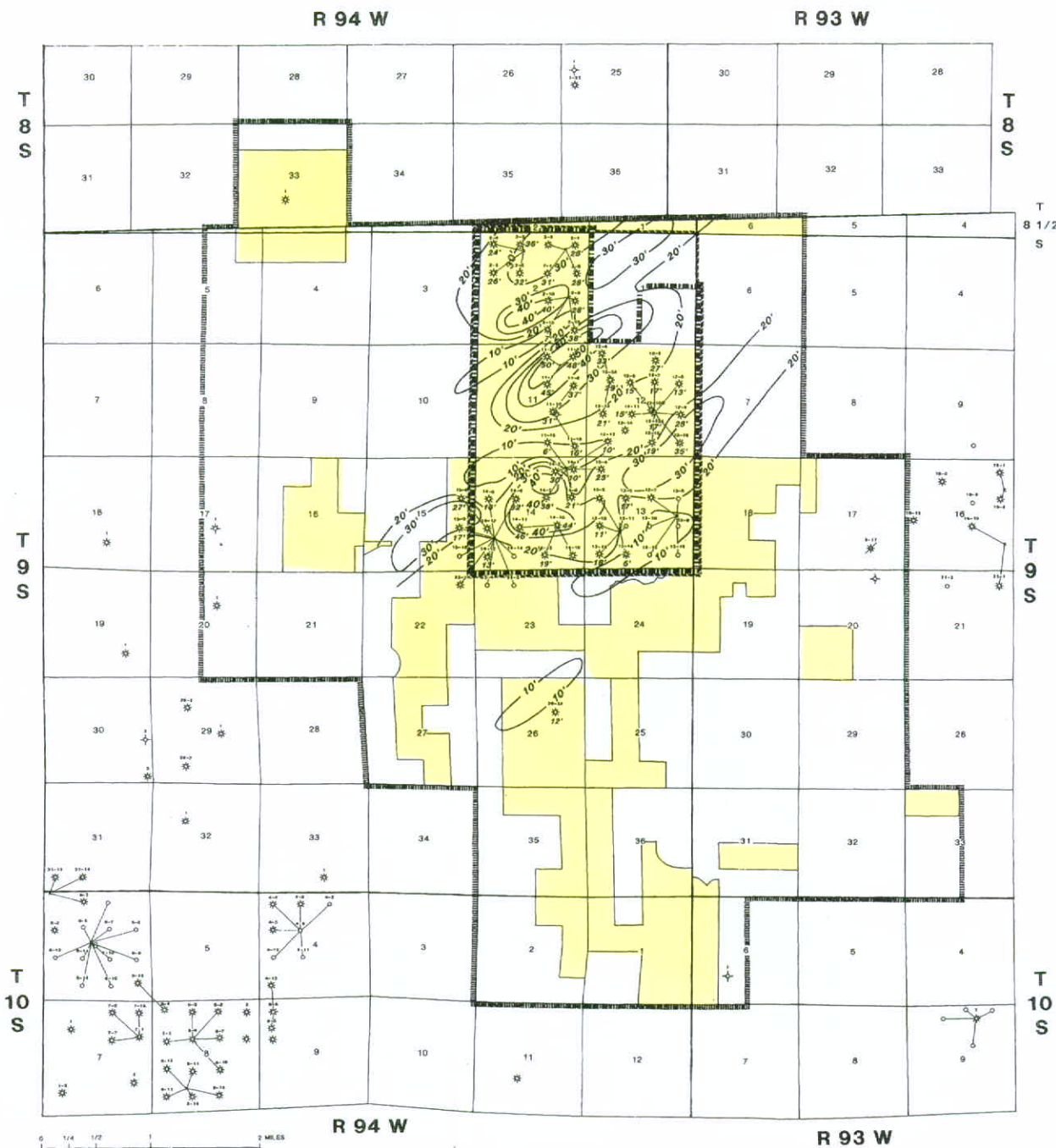

T. D. Kirkpatrick

Cause No. 429
Docket No. 0606-AW-08
Williams Fork Fm.
Basin Centered
Gas System
Isopach:
Gas Saturated Interval
C.I. = 250 Feet
Mesa County, Colorado
Brush Creek Field



INDEX MAP

- LEGEND -

-  SPACED AREA
-  APPLICATION AREA
-  PRIOR APPLICATION AREAS
-  LARAMIE ENERGY, LLC LEASEHOLD

<p>Exhibit No. 4</p> <p>Laramie Energy, LLC</p> <p>T. D. Kirkpatrick</p>	<p>Cause No. 429 Docket No. 0606-AW-08</p> <p>Cozzette Net Sand Isopach (Net .578API 6% Density Porosity) C.I. = 10 Feet</p> <p>Mesa County, Colorado Brush Creek Field</p>
--	--

BRUSH CREEK | BRUSH CREEK NEW WELL MONTHLY TYPE CURVE | CORCORAN COZZETTE MESAVER | MISC |

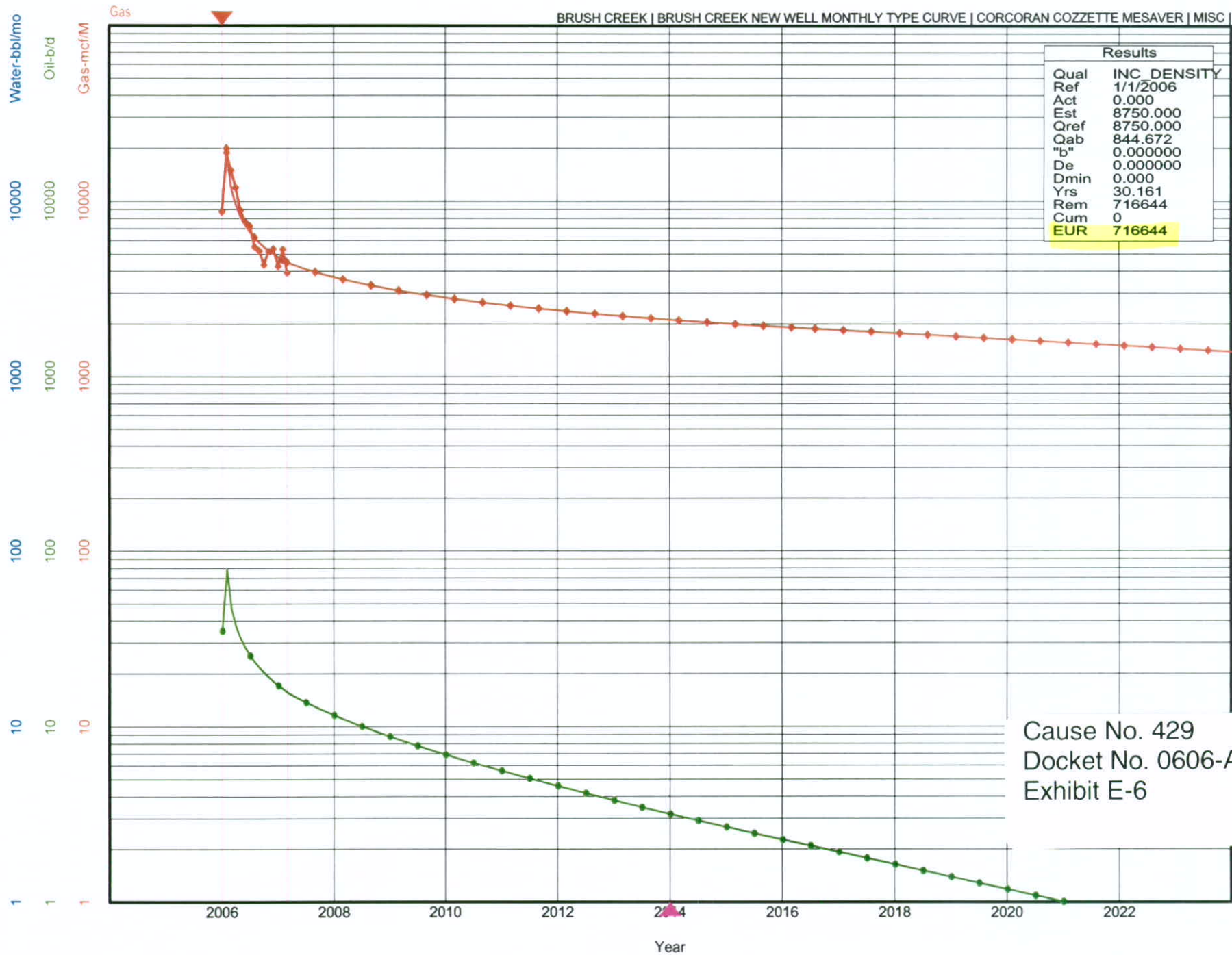

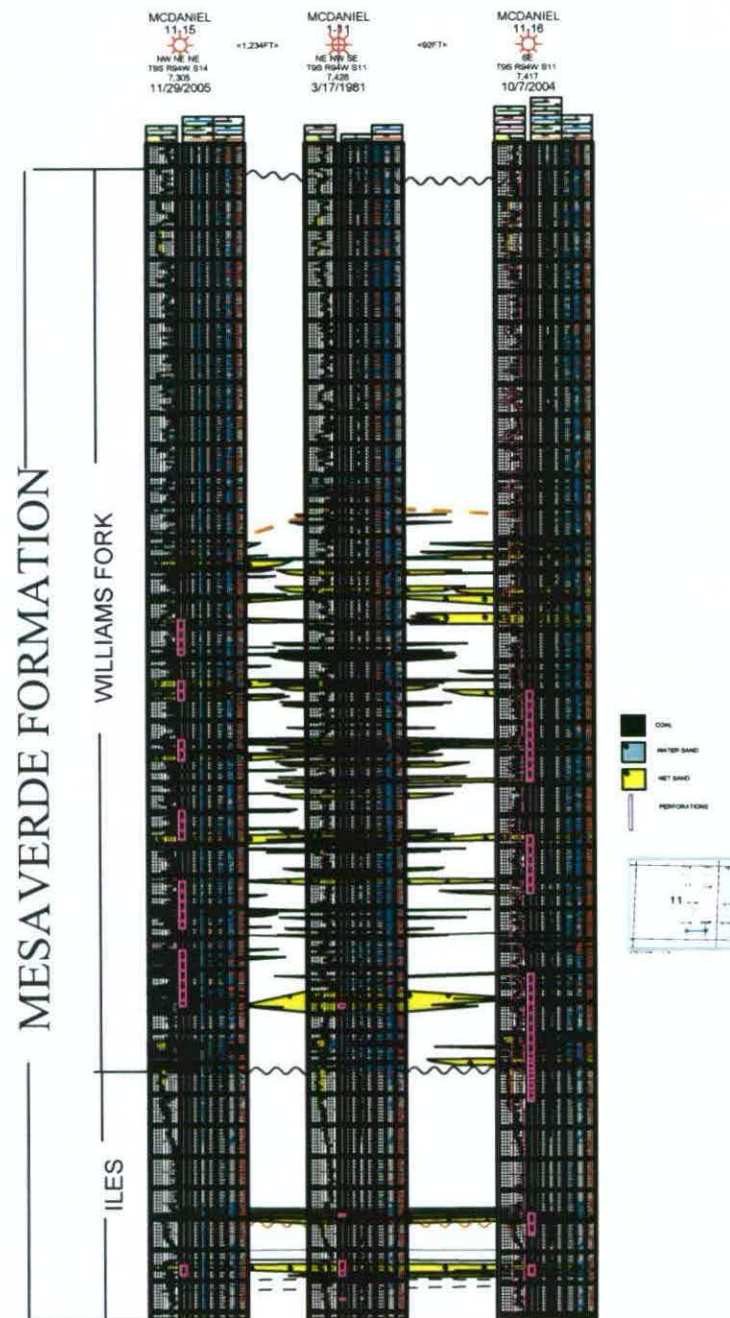

Exhibit No. 5	Case No. 428 Doc No. 0606A01-07
Latona Energy, LLC	West to East Stratigraphic Cross Section A-A'
T. D. Kuznetsov	Meas County, Colorado Brush Creek Field